



Grove Road

Harpenden, AL5 1QG

Beautifully refurbished period cottage with open plan living space and a 50ft south facing garden. Moments from both the amenities of Southdown and The Common and within walking distance of Harpenden town centre and station. *CHAIN FREE*

Offers in excess of £475,000

Grove Road

Harpenden, AL5 1QG



- Immaculately presented
- Open plan living space
- Close to The Common
- Refurbished by our clients
- Garden 50ft, south facing
- Walking distance to town centre & station
- Period cottage
- Moments from amenities of Southdown
- Chain Free

Entrance Hall

Living Room

20'10" (max) x 11'1" (max) (6.37 (max) x 3.38 (max))

Kitchen

6'11" x 7'10" (2.12 x 2.40)

Bedroom One

11'4" x 11'1" (max) (3.47 x 3.38 (max))

Bedroom Two

9'6" x 5'2" (max) (2.91 x 1.58 (max))

Shower Room

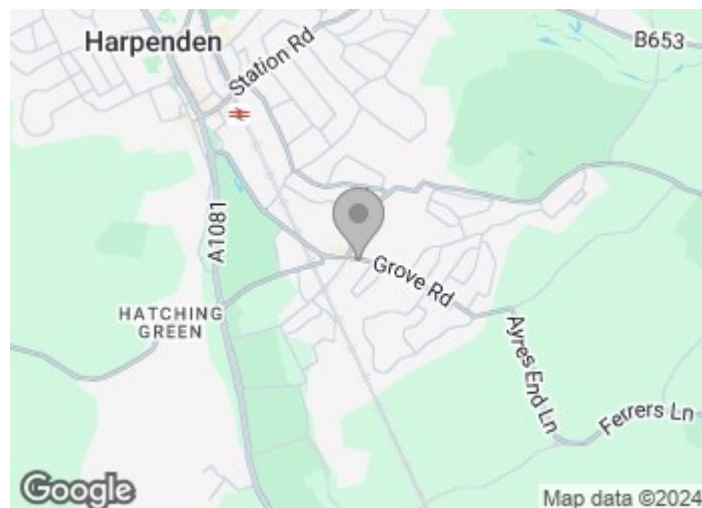



Ground Floor

Approx. 26.9 sq. metres (289.0 sq. feet)

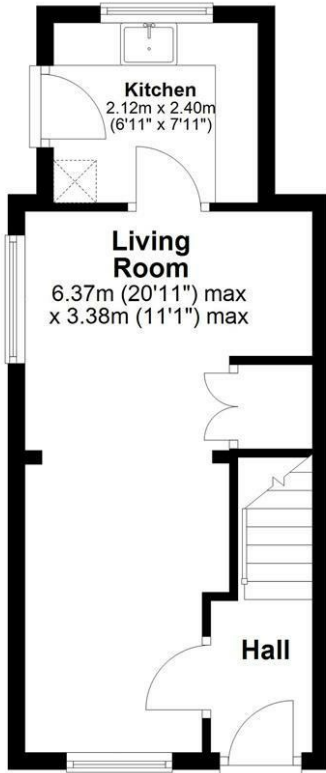

First Floor

Approx. 21.8 sq. metres (234.4 sq. feet)

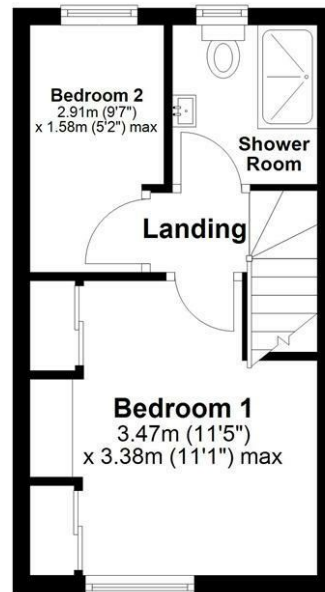

Total area: approx. 48.6 sq. metres (523.4 sq. feet)

Sketch layout only. Not to scale. Plan produced for Whittaker & Co.

Plan produced using PlanUp.

These particulars, whilst believed to be accurate are set out as a general outline only for guidance and do not constitute any part of an offer or contract. Intending purchasers should not rely on them as statements of representation of fact, but must satisfy themselves by inspection or otherwise as to their accuracy. No person in this firm's employment has the authority to make or give any representation or warranty in respect of the property.

