



Batford Road

Harpenden, AL5 5AX

An extremely well presented period home which has been refurbished throughout by the current owners. The south west facing garden is circa 70ft. This property offers potential for a loft conversion and extension STPP. Batford Road is well placed for schooling, moments From beautiful open countryside and within walking distance of the town centre and station. ** CHAIN FREE **

Guide price £525,000

Batford Road

Harpenden, AL5 5AX



- Well presented period home
- Well placed for schooling
- Potential for loft conversion and extension STPP
- Refurbished throughout
- Close to open countryside
- **CHAIN FREE**
- South west facing garden circa 70ft
- Walking distance to the town centre and station

Living Room

12'2" x 11'1" (3.72m x 3.40m)

Dining Room

12'3" x 11'1" (3.74m x 3.40m)

Kitchen

14'0" x 7'0" (4.27m x 2.14m)

Bedroom 1

11'1" x 10'4" (3.40m x 3.16m)

Bedroom Two

8'11" x 7'0" (2.73m x 2.14m)

Study/Bedroom Three

8'1" x 7'6" (2.47m x 2.30m)

Bathroom

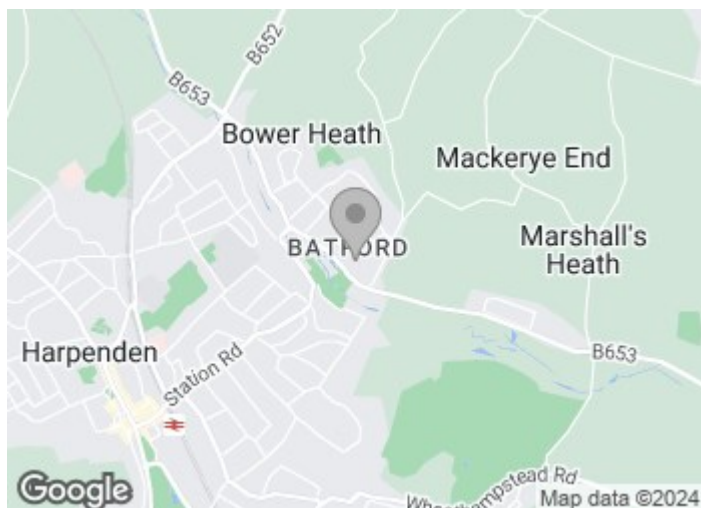



Floor Plan

Ground Floor
Approx. 33.7 sq. metres (362.9 sq. feet)

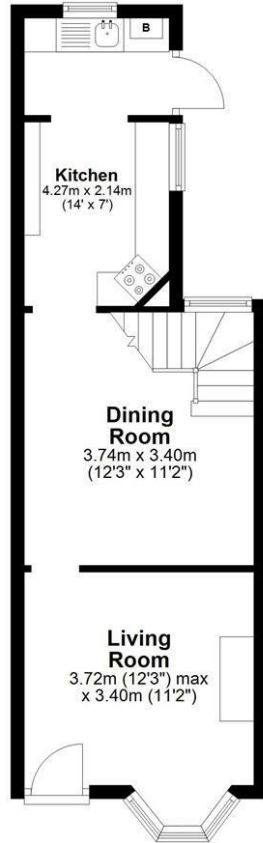

First Floor
Approx. 29.9 sq. metres (321.4 sq. feet)

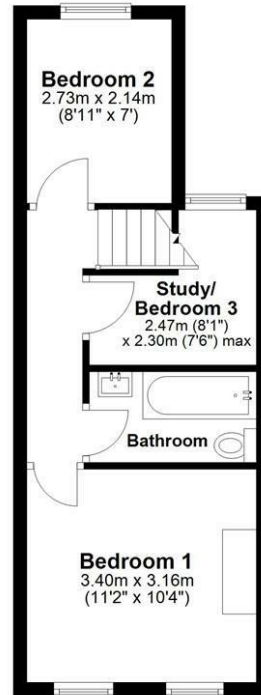

Total area: approx. 63.6 sq. metres (684.3 sq. feet)

Sketch layout only. Not to scale. Plan produced for Whittaker & Co.

Plan produced using PlanUp.

These particulars, whilst believed to be accurate are set out as a general outline only for guidance and do not constitute any part of an offer or contract. Intending purchasers should not rely on them as statements of representation of fact, but must satisfy themselves by inspection or otherwise as to their accuracy. No person in this firm's employment has the authority to make or give any representation or warranty in respect of the property.

