



## Townsend Lane Harpenden, AL5 2FE

Extremely well presented apartment on the first floor (walk up), of this exclusive development in a prime central location, within minutes of the town centre and station. Beautiful communal gardens. Allocated parking space plus visitor parking. Lease 117 years remaining. \*CHAIN FREE\*

**Guide price £499,950**

# Townsend Lane

Harpenden, AL5 2FE



- First floor apartment (walk up)
- Open plan living space
- Well proportioned rooms
- Allocated parking plus visitor parking
- Central location
- Communal gardens
- Lease 117 years remaining
- Exclusive development
- Chain Free

## Entrance Hall

## Lounge / Dining Room

16'1" x 12'5" (4.92 x 3.79)

## Kitchen

14'7" x 11'2" (4.47 x 3.42)

## Bedroom One

15'4" x 8'8" (4.69 x 2.66)

## Bedroom Two

11'5" x 10'2" (3.48 x 3.11)

## Bathroom





## Floor Plan

Approx. 67.1 sq. metres (721.8 sq. feet)

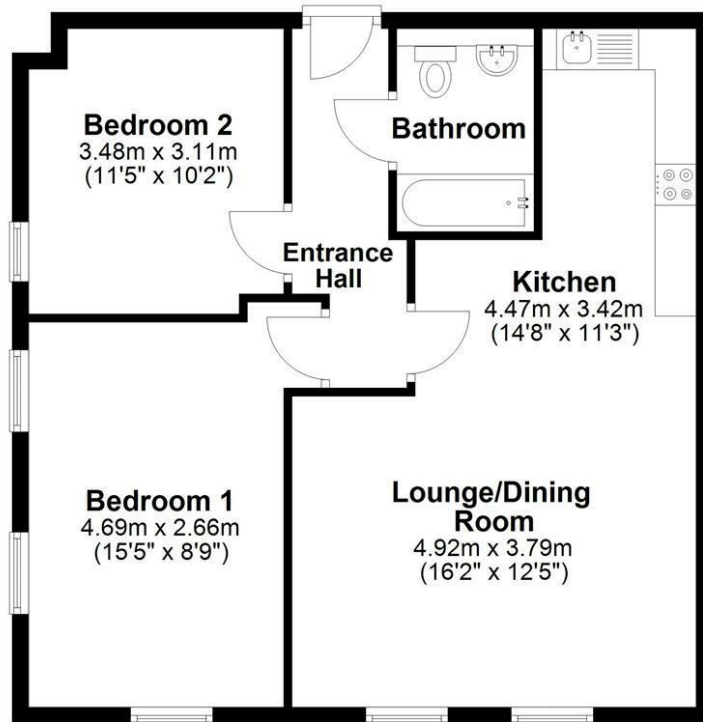

Total area: approx. 67.1 sq. metres (721.8 sq. feet)

Sketch layout only. Not to scale. Plan produced for Whittaker & Co.

Plan produced using PlanUp.

These particulars, whilst believed to be accurate are set out as a general outline only for guidance and do not constitute any part of an offer or contract. Intending purchasers should not rely on them as statements of representation of fact, but must satisfy themselves by inspection or otherwise as to their accuracy. No person in this firm's employment has the authority to make or give any representation or warranty in respect of the property.

