



Eastmoor Park

Harpenden, AL5 1AS

Built circa twenty years ago, this three bedroom home is arranged over three floors. Additional benefits of a private garden and garage en bloc. Close to both the amenities of Southdown and the Common and within walking distance of Harpenden and the station. *CHAIN FREE*.

Guide price £425,000

Eastmoor Park

Harpenden, AL5 1AS



- Built circa 20 years ago
- Three Bedrooms
- Garage en bloc
- Arranged over three floors
- Two Bathrooms
- Close to amenities of Southdown
- Open plan living space
- Private garden
- Chain Free

Entrance Hall

Kitchen

12'2" x 5'4" (3.71 x 1.65)

Living Room

12'7" x 11'5" (3.86 x 3.50)

Cloakroom

Bedroom Two

10'2" (max) x 11'5" (3.10 (max) x 3.50)

Bedroom Three

7'11" x 5'4" (2.43 x 1.65)

Family Bathroom

Bedroom One

16'7" x 8'3" (max) (5.06 x 2.52 (max))

En-suite Bathroom

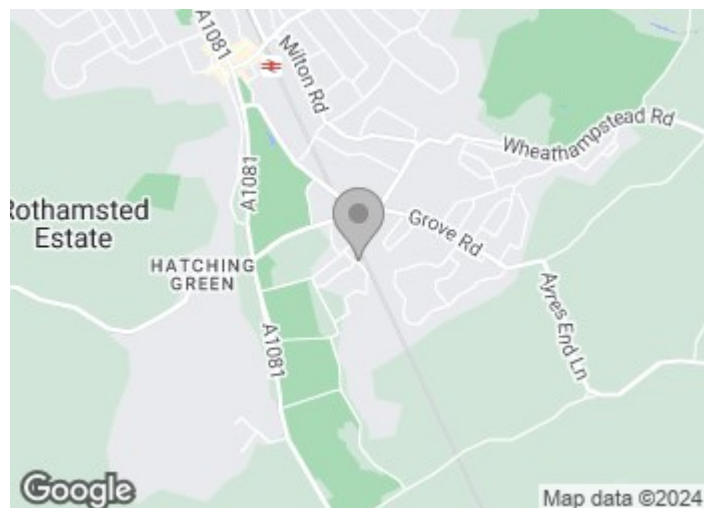

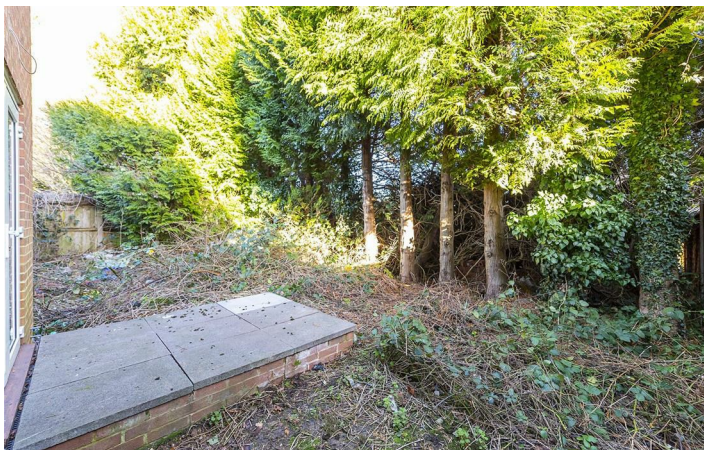

Floor Plan

Ground Floor
Approx. 26.9 sq. metres (289.0 sq. feet)

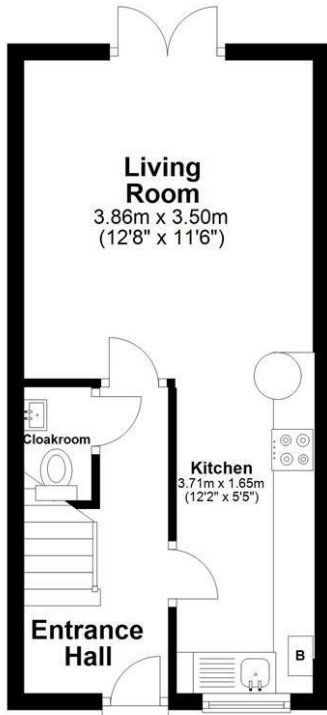

First Floor
Approx. 26.7 sq. metres (287.9 sq. feet)

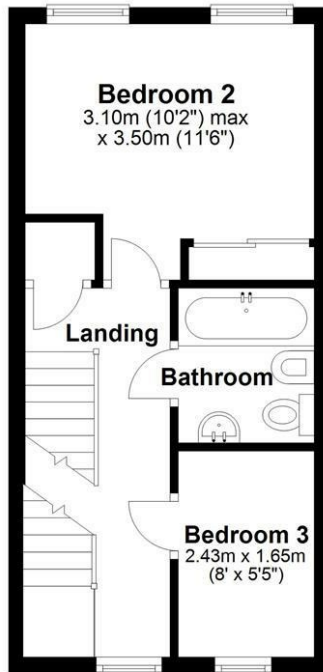

Second Floor
Approx. 17.7 sq. metres (190.7 sq. feet)



Total area: approx. 71.3 sq. metres (767.6 sq. feet)

Sketch layout only. Not to scale. Plan produced for Whittaker & Co.

Plan produced using PlanUp.

These particulars, whilst believed to be accurate are set out as a general outline only for guidance and do not constitute any part of an offer or contract. Intending purchasers should not rely on them as statements of representation of fact, but must satisfy themselves by inspection or otherwise as to their accuracy. No person in this firm's employment has the authority to make or give any representation or warranty in respect of the property.

