



ICONIC  
ESTATE AGENTS

Drayton Hall Park, Drayton  
OIEO £65,000 Share Of Freehold



- Attractive Park Home
- Entrance Hall
- One Double Bedroom With Built-In Storage
- Generous Galley Style Kitchen
- Open Plan Sitting/Dining Room
- Shower Room
- Lovely Wrap Around Gardens
- Offered In Good Condition Throughout
- Offered With No Onward Chain
- Council Tax Band A



## GROUND FLOOR

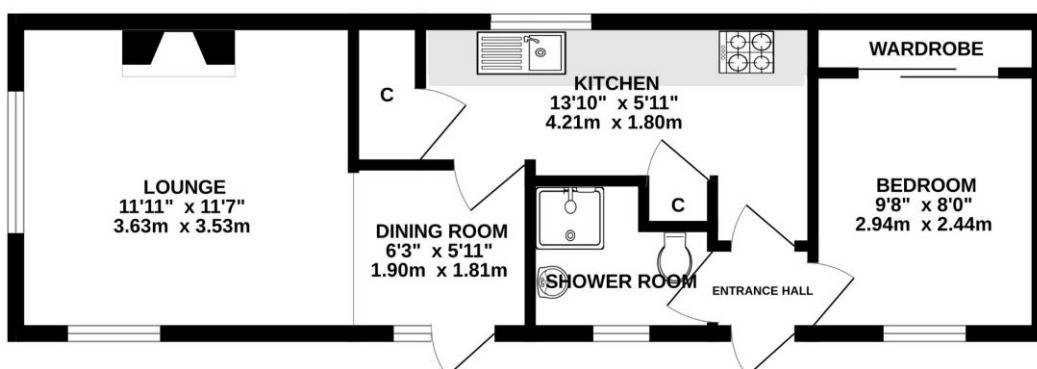

Whilst every attempt has been made to ensure the accuracy of the floorplan contained here, measurements of doors, windows, rooms and any other items are approximate and no responsibility is taken for any error, omission or mis-statement. This plan is for illustrative purposes only and should be used as such by any prospective purchaser. The services, systems and appliances shown have not been tested and no guarantee as to their operability or efficiency can be given.  
Made with Metropix ©2025

Leave Norwich on the Drayton Road and continue into Drayton. Turn right at the traffic lights onto School Road and take the second exit at the mini roundabout onto Hall Road. Continue on this road and turn third right into Drayton Hall Park where the property can be found on the left hand side.

Agents Notes: Site Fees are £208.00 pcm (please ask for further details).

Viewings strictly by appointment with: 297 Fakenham Road, Norwich, NR8 6LE

Taverham **01603 261104**  
Norwich **01603 740044**

rightmove

zoopla

onTheMarket.com

THE  
GUILD  
PROPERTY  
PROFESSIONALS

We bring to prospective purchasers attention that we, as estate agents for the property, have not tested any appliances and purchasers should make their own enquiries of the relevant Authorities regarding the connection and viability of all services. These particulars, whilst believed to be accurate are set out as a general outline only for guidance and do not constitute any part of an offer or contract. Intending purchasers should not rely on them as statements of representation of fact, but must satisfy themselves by inspection or otherwise as to their accuracy.