



ICONIC
ESTATE AGENTS

Trimming Walk, Taverham
OIEO £240,000 - Freehold



- Extended & Improved End Of Terrace House
- Two Double Bedrooms
- Extended 21ft Open Plan Kitchen/Breakfast Room
- 19ft Lounge/Diner
- Re-Fitted Family Bathroom Suite
- Enclosed Rear Garden
- Ample Off Road Parking
- Close To Local Schools & Amenities
- Sought After End Of Cul-de-Sac Position
- EPC Rating D / Council Tax Band B



GROUND FLOOR

1ST FLOOR

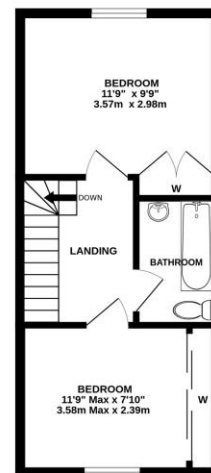
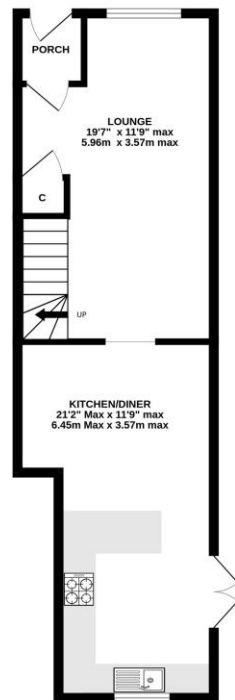

From Taverham Road, turn into Shakespeare Way and continue to the end of the road. Follow the road round to the left onto Cameron Green. Take the second right into Trimming Walk where the property can be found on the right hand side at the end of the cul-de-sac.

Viewings strictly by appointment with: 297 Fakenham Road, Norwich, NR8 6LE

Taverham **01603 261104**
Norwich **01603 740044**

rightmove

zoopla

OnTheMarket.com

THE GUILD
PROPERTY
PROFESSIONALS

We bring to prospective purchasers attention that we, as estate agents for the property, have not tested any appliances and purchasers should make their own enquiries of the relevant Authorities regarding the connection and viability of all services. These particulars, whilst believed to be accurate are set out as a general outline only for guidance and do not constitute any part of an offer or contract. Intending purchasers should not rely on them as statements of representation of fact, but must satisfy themselves by inspection or otherwise as to their accuracy.