



ICONIC
ESTATE AGENTS

Newton Street, Newton St Faith
£230,000 Freehold



- Semi Detached Bungalow
- Entrance Hallway
- Two Double Bedrooms
- Modern Kitchen
- Lounge & Conservatory
- Recently Re-Fitted Wet Room
- Ample Storage
- Corner Plot Position
- Offered With No Onward Chain
- EPC Rating / Council Tax Band B



GROUND FLOOR

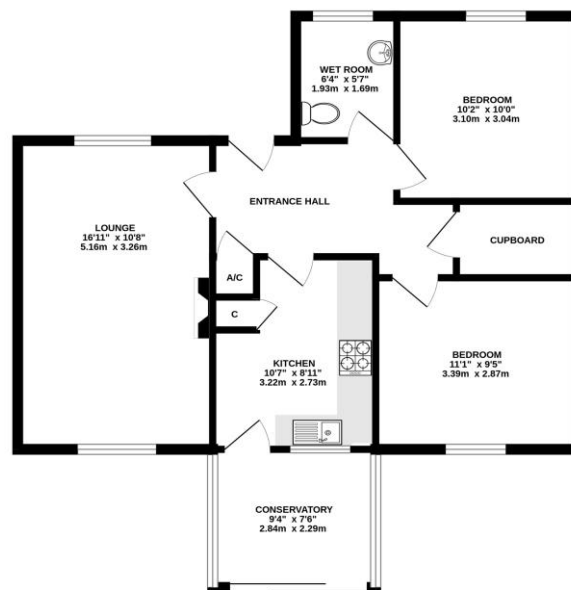

Whilst every attempt has been made to ensure the accuracy of the floorplan contained herein, measurements of doors, windows, rooms and any other items are approximate and no responsibility is taken for any error, omission or misstatement. This plan is for illustrative purposes only and should be used as such by any prospective purchaser. The services, systems and appliances shown have not been tested and no guarantee as to their operation or condition can be given. Made with Metaphor software.

From the A140 Cromer Road turn right towards Newton St Faith onto Manor Road. Follow the road round into Newton Street where the property can be found on the left hand side.

Viewings strictly by appointment with: 297 Fakenham Road, Norwich, NR8 6LE

Taverham **01603 261104**
Norwich **01603 740044**

rightmove

zoopla

onTheMarket.com

THE
GUILD
PROPERTY
PROFESSIONALS

We bring to prospective purchasers attention that we, as estate agents for the property, have not tested any appliances and purchasers should make their own enquiries of the relevant Authorities regarding the connection and viability of all services. These particulars, whilst believed to be accurate are set out as a general outline only for guidance and do not constitute any part of an offer or contract. Intending purchasers should not rely on them as statements of representation of fact, but must satisfy themselves by inspection or otherwise as to their accuracy.