



ICONIC
ESTATE AGENTS

Gunton Lane, New Costessey £1000 pcm Freehold



- Spacious End Of Terrace House
- Porch Entrance
- Three Bedrooms
- Spacious Lounge
- Modern Kitchen
- Dining Room
- Four Piece Family Bathroom Suite
- Rear Garden
- Garage & Parking
- EPC Rating D / Council Tax Band B

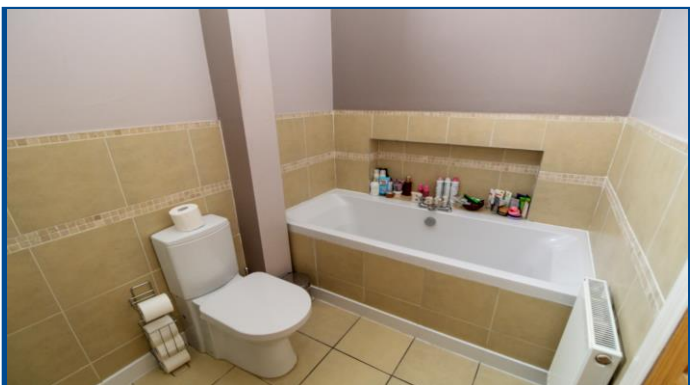

GROUND FLOOR

1ST FLOOR

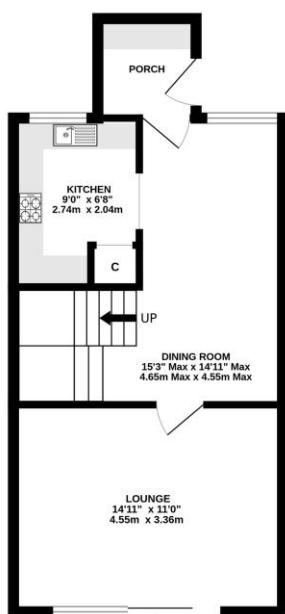

Whilst every attempt has been made to ensure the accuracy of the floorplan contained here, measurements of doors, windows, rooms and any other items are approximate and no responsibility is taken for any error, omission or misstatement. This plan is for illustrative purposes only and should be used as such by any prospective purchaser. The services, systems and appliances shown have not been tested and no guarantee is given for their operation or efficiency under any given conditions.
Made with Mettpro 0.0028

Leave Norwich via the Dereham Road heading towards Costessey. Turn right into Norwich Road and continue along. Turn right into Oval Road to the end, turn left onto Gunton Lane where the property can be found on the left hand side indicated by our To Let Board.

Viewings strictly by appointment with: 297 Fakenham Road, Norwich, NR8 6LE

Taverham **01603 261104**
Norwich **01603 740044**

rightmove

zoopla

onTheMarket.com

THE GUILD
PROPERTY
PROFESSIONALS

We bring to prospective purchasers attention that we, as estate agents for the property, have not tested any appliances and purchasers should make their own enquiries of the relevant Authorities regarding the connection and viability of all services. These particulars, whilst believed to be accurate are set out as a general outline only for guidance and do not constitute any part of an offer or contract. Intending purchasers should not rely on them as statements of representation of fact, but must satisfy themselves by inspection or otherwise as to their accuracy.