



5 Regency Court, Melcombe Avenue, Weymouth, DT4 7TH

Monthly Rental Of £625

5 Regency Court Melcombe Avenue,

- First Floor Apartment
- PARKING Available
- Close To The TOWN CENTRE & Greenhill Gardens
- Good Size Bedroom
- Spacious Accommodation
- INTEGRATED Kitchen Appliances
- Decorated To A Good Standard

Description

Meyers are delighted to be marketing this SPACIOUS one bedroom FIRST FLOOR apartment in Weymouth, situated close to town centre and Greenhill gardens. Accommodation comprises; Entrance hall, open plan living room / Dining room, Kitchen with FITTED APPLIANCES LARGE bedroom, and bathroom. ALLOCATED PARKING and communal grounds.

Entrance Hall

Doors to ; bedroom, bathroom and living room.

Living Room

Side aspect double glazed doors to Juliet balcony, gas coal effect fire, television point, satellite television point, wall lighting, coving, two ceiling light points, wall mounted radiator, wood effect flooring, archway through to :-

Bedroom 13' 0" x 11' 0" (3.96m x 3.35m)

Very light and airy. window to side aspect, wooden effect flooring, wall mounted radiator, TV point.



Kitchen 8' 10" x 8' 4" (2.69m x 2.54m)

Sash window to side aspect, eye and base units tiled to all splash prone areas, integrated electric oven and gas hob with extractor hood overhead. Space and plumbing for washing machine, space for fridge freezer. Boiler cupboard.

Bathroom 7' 8" x 6' 0" (2.34m x 1.83m)

Sash window to side aspect, marble effect tiled flooring, panel enclosed bath with shower overhead, pedestal wash band basin, low level W.C

Parking

One allocated parking space.



GROUND FLOOR 46.81 sq. m.
(503.89 sq. ft.)

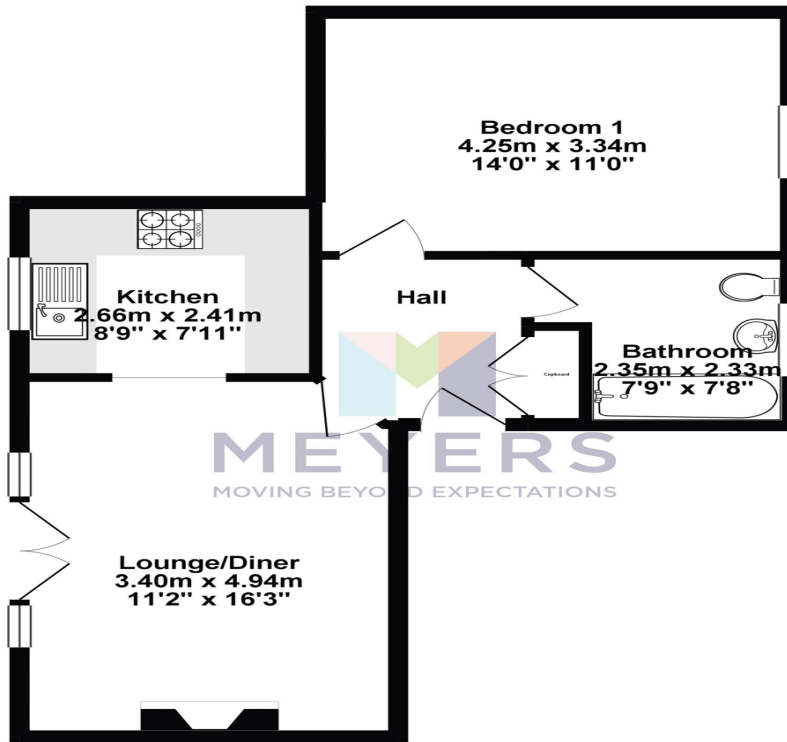

TOTAL FLOOR AREA : 46.81 sq. m. (503.89 sq. ft.) approx.

Whilst every attempt has been made to ensure the accuracy of the floorplan contained here, measurements of doors, windows, rooms and any other items are approximate and no responsibility is taken for any error, omission or mis-statement. This plan is for illustrative purposes only and should be used as such by any prospective purchaser. The services, systems and appliances shown have not been tested and no guarantee as to their operability or efficiency can be given.
Made with Metropix ©2019

Directions

From Weymouth town centre follow the Esplanade and at St John's Church bear right, continue round and turn immediately left into Melcombe Avenue, the property is situated on the right hand side.

Lettings Office Open

Meyers Estate Agents have a highly successful letting department, which includes management at competitive fees and valuable service levels. If you require a rental valuation or further information please call us today on 01305 236248



MEYERS
MOVING BEYOND EXPECTATIONS

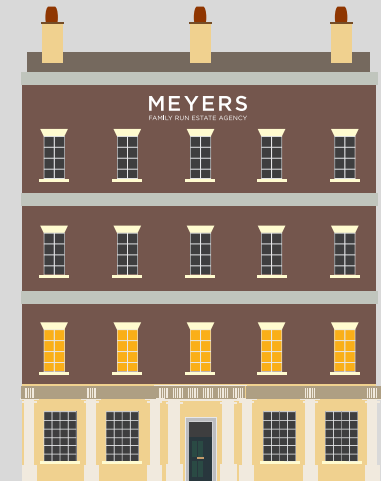

01305 259436

info@meyersestates.com

1 Queen Mother Square
Poundbury, Dorset, DT1 3BL

Request an *instant* property valuation at:
www.meyersestates.com

Sales

Lettings

Mortgages

We have prepared these property particulars as a general guide to a broad description of the property. They are not intended to constitute part of an offer or contract. We have not carried out a structural survey and the services, appliances and specific fittings have not been tested. All photographs, measurements, floor plans and distances referred to are given as a guide only and should not be relied upon for the purchase of carpets or any other fixtures or fittings. Lease details, service charges and ground rent (where applicable) and council tax are given as a guide only and should be checked and confirmed by your Solicitor prior to exchange of contracts. The copyright of all details, photographs and floor plans remain exclusive to Meyers Estate Agents.