

1 Queen Mother Square, Poundbury, DT1 3BL

Tel: 01305 259436

Email: [info@meyersstates.com](mailto:info@meyersstates.com)

[www.meyersstates.com](http://www.meyersstates.com)

*Your Local Award Winning Estate Agency*



**MEYERS**

MOVING BEYOND EXPECTATIONS



## Stevens Farm House

Dorchester DT2 9JR

- Four Bedroom House
- Two Reception Rooms
- Master Bedroom with Ensuite
- Character Features Throughout
- Feature Fireplaces
- Grade 2 Listed Property



## Description

A beautiful example of a grade 11 listed building, comprising of large living space, character features and good size bedrooms plus ensuite. The garden wraps around one side of the property with mostly patio slabs and shingle with mature flowers and plants providing a nice feeling of being enclosed, while also being fully fenced around.

### Entrance hallway

Entrance hallway from the side of the property has one main door and a small storage cupboard to the side and then another door into the main hallway, there is then a door to kitchen and sitting room and then goes through into the dining area and main entrance from the front of the property

### Kitchen

Character kitchen with wall and base units, wooden work surface, side aspect secondary glazed window above the sink which is a one and a half bowl stainless steel sink with mixer tap, part tiled walls, space for free standing gas hob and cooker, towel rail, feature serving hatch to dining room, door to pantry with space for fridge freezer, integrated dishwasher and washing machine

### Sitting Room

Two front aspect bay windows with feature marble effect fireplace with gas fire in situ. storage cupboard and radiator

### Dining area

Main door to the front of the house opens up into the dining space, with stairs to the first floor, radiator

### First Floor landing

front aspect window, doors to all bedrooms and bathroom

### Bedroom 4

sky light

### Bathroom

part tiled walls, free standing hand wash pedestal with mixer tap, light up mirror. panel bath with over head mains fed shower, mixer tap, low level w/c, rear aspect window, towel rail

### Bedroom 2

front aspect window, radiator.

### Bedroom 3

front aspect window, radiator and a built in wardrobe

### Master Bedroom

side aspect window, built in wardrobe plus door to ensuite

### Ensuite

walk in shower cubicle with mains fed shower, pedestal hand wash basin and low level wc.

### Garden

garden is a side garden with access to storage shed with combination boiler, garden is paved with some shingle, with mature trees and shrubs. all enclosed with fencing.

### Meyers Properties

For the opportunity to see properties before they go on the market 'like' our page on Facebook here <https://www.facebook.com/meyersestateagents/>

## Important Note

These particulars are believed to be correct but their accuracy is not guaranteed. They do not form part of any contract. Nothing in these particulars shall be deemed to be a statement that the property is in good structural condition or otherwise, nor that any of the services, appliances, equipment or facilities are in good working order or have been tested. Purchasers should satisfy themselves on such matters prior to purchase.

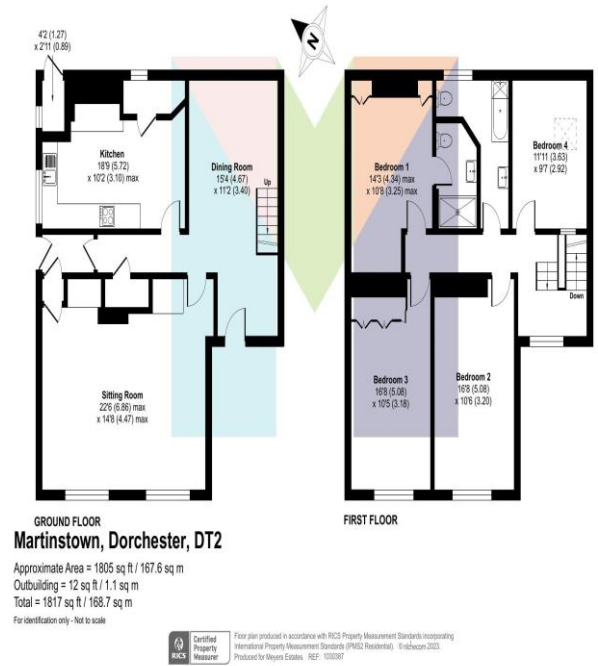

Meyers are recommendation based family estate agents with a simple goal to provide you with an exceptional level of service, combining good old fashioned values with cutting edge marketing for your home. We are passionate about the local area and care greatly about our community and our contribution towards it. Our Poundbury HQ office happily cover Dorchester, Weymouth, Portland, Blandford, Sherborne, Yeovil, Bridport and the countryside in between, along with surrounding towns and villages. We offer a full range of services including Sales, Lettings, Professional and Drone Photography, London Marketing Exhibitions, Independent Financial Advice and the conveyancers to help you move. Call us today FREEPHONE on 0800 8499256 for help selling your house today.

