

Eastmoor

Cotgrave
Nottingham
NG12 3NU

Guide Price £190,000



Click for further information:-



Location



Gallery



Video



Contact



0115 841 1155



- Terraced house
- 3 Bedrooms
- Kitchen/diner
- Modern bathroom
- Outdoor store
- Rear garden & patio
- Driveway
- EPC - Band C
- Tenure - Freehold
- Council Tax - Band A



0115 841 1155



Location



Gallery



Video



Contact

Eastmoor, [Cotgrave, Nottingham, NG12 3NU](#)

Situated in the popular and well-connected village of Cotgrave, this well presented 3-bedroom terraced home offers both space and comfort, perfect for families, first-time buyers, or those looking to upsize.

Step through the inviting entrance hallway into a generously sized living room, ideal for relaxing evenings or entertaining guests. At the rear of the property, you'll find a kitchen diner – the true heart of the home – with ample space for family meals and direct access to the rear patio and garden. Upstairs, the property boasts three well-proportioned bedrooms, offering flexibility for sleeping, working from home, or guest accommodation.

Outside, the private rear garden is a peaceful retreat, complete with a patio area perfect for summer barbecues. To the front, a driveway provides convenient off-street parking.

Set in a residential area, yet within easy reach of local amenities, schools, and transport links, this lovely home combines practicality with charm.





0115 841 1155



Location



Gallery



Video



Contact

Eastmoor, [Cotgrave, Nottingham, NG12 3NU](#)



Ground Floor

Approx. 44.0 sq. metres (473.7 sq. feet)

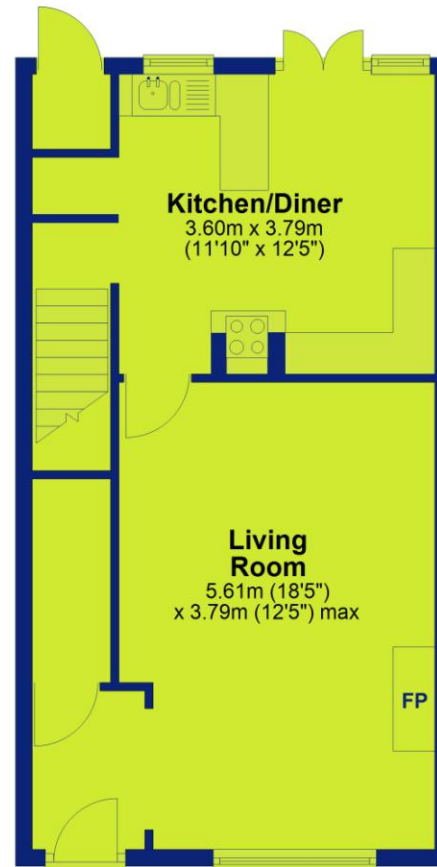

First Floor

Approx. 43.5 sq. metres (468.2 sq. feet)

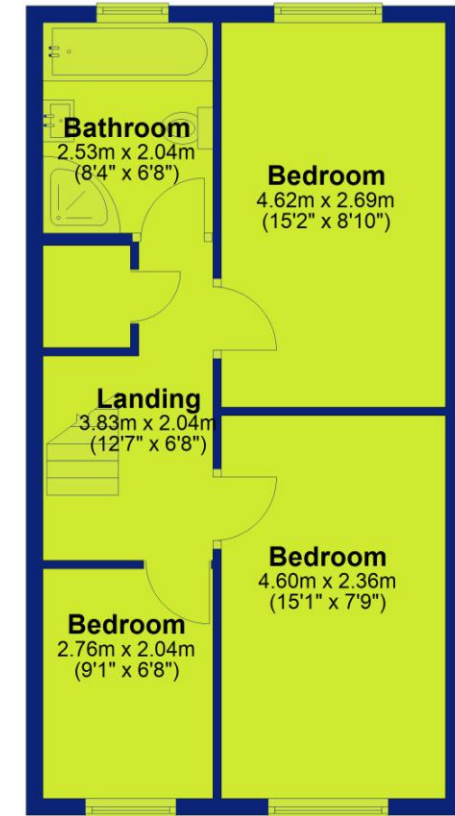

Total area: approx. 87.5 sq. metres (941.9 sq. feet)



0115 841 1155



Location



Gallery



Video



Contact

Eastmoor, [Cotgrave, Nottingham, NG12 3NU](#)



Interested in this home?

Contact the FHP Living Team on 0115 841 1155

23 Bridgford Road
West Bridgford
Nottingham
NG2 6AU

1 Weekday Cross
The Lace Market
Nottingham
NG1 2GB

Score	Energy rating	Current	Potential
92+	A		
81-91	B		87 B
69-80	C	74 C	
55-68	D		
39-54	E		
21-38	F		
1-20	G		

These sales particulars have been prepared by FHP Living on the instruction of the vendor. Services, equipment and fittings mentioned in these particulars have NOT been tested, and as such, no warranties can be given. Prospective purchasers are advised to make their own enquiries regarding such matters. These sales particulars are produced in good faith and are not intended to form part of a contract. Whilst FHP Living have taken care in obtaining internal measurements, they should only be regarded as approximate.

Purchaser information - Under the Protecting Against Money Laundering and the Proceeds of Crime Act 2002, FHP Living require any successful purchasers proceeding with a purchase to provide two forms of identification i.e. passport or photocard driving license and a recent utility bill. This evidence will be required prior to FHP Living instructing solicitors in the purchase or the sale of a property.