

93 Ella Road

West Bridgford
Nottingham
NG2 5GZ

Guide Price £535,000 - £565,000



Click for further information:-



Location



Gallery



Video



Contact



0115 841 1155



- Four-bedroom semi-detached home
- Family bathroom, en-suite and downstairs WC
- Accommodation across three floors
- Two reception rooms
- Off street parking
- Central West Bridgford location
- Highly regarded school catchment area
- Viewing essential!
- Council Tax Band - C
- Tenure - Freehold



0115 841 1155



Location



Gallery



Video



Contact

93 Ella Road, [West Bridgford, Nottingham, NG2 5GZ](#)

Key Features

A charming period four-bedroom semi-detached home, ideally situated in the heart of the highly sought-after Nottingham suburb of West Bridgford. Offering off-street parking and a private rear garden, this property is located within desirable school catchment areas. Early viewing is strongly recommended, as we anticipate a high level of interest.

The property is entered through a composite front entrance door, leading to an original arched porch and internal vestibule. The main front door opens into a spacious reception hall, with stairs rising to the second floor. Doors lead to the generously sized lounge, which features a large bay window to the front, allowing natural light to flood the room. The lounge also benefits from built-in shutter blinds and showcases original ceiling coving, a picture rail, and a stunning period-style Art Nouveau fireplace with a cast-iron surround and tiled open hearth. Adjacent is a dining/family room, also with period features, including a cast-iron fireplace set on a stone hearth, original ceiling coving, and a window to the rear elevation. The room also includes a serving hatch that opens into the kitchen.

The kitchen provides space for a dining table and is fitted with a range of buttermilk-fronted wall and base units, complemented by wooden worktops. It has space for a cooking range, with a splashback and extractor, and a Belfast sink set beneath a double-glazed window, offering views over the garden. The kitchen also features contemporary-style flooring, a modern radiator, and an additional window to the side elevation. A door leads to a WC with a two-piece contemporary suite.

To the first floor, the landing provides access to three well-proportioned bedrooms, with the master bedroom spanning the width of the property. There is a family bathroom with travertine-style flooring and wall tiles, featuring a freestanding bath with a shower over, a vanity unit with a wash basin, a low flush WC, and a wall-mounted TV (currently out of use). The top floor has a converted loft, providing an additional bedroom with an en-suite shower room, fitted with a modern three-piece suite.

To the front of the property, a gravel driveway offers parking for cars and provides access to the house, with a pathway leading to the side. The rear garden features a paved patio area directly accessible from the kitchen, ideal for seating. The garden is mainly laid to lawn and surrounded by shrub borders, a fruit tree, and an original stone wall boundary. Additionally, there is a brick-built outbuilding offering excellent storage.





0115 841 1155



Location



Gallery



Video



Contact

93 Ella Road, [West Bridgford, Nottingham, NG2 5GZ](#)



Ground Floor
Approx. 55.1 sq. metres (593.3 sq. feet)

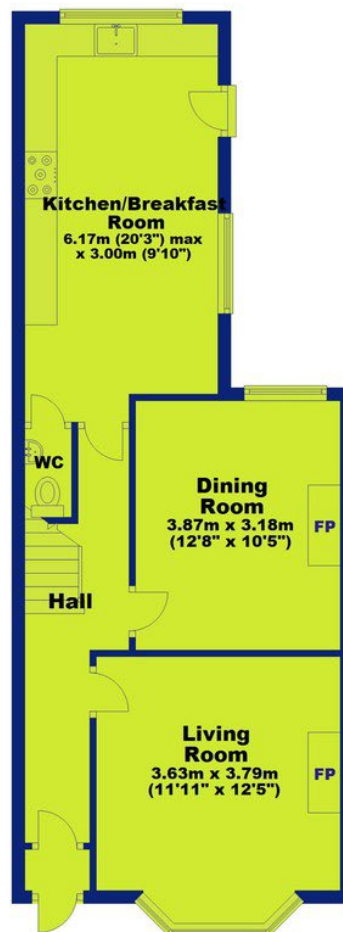

First Floor
Approx. 55.0 sq. metres (592.1 sq. feet)



Second Floor
Approx. 23.1 sq. metres (249.0 sq. feet)

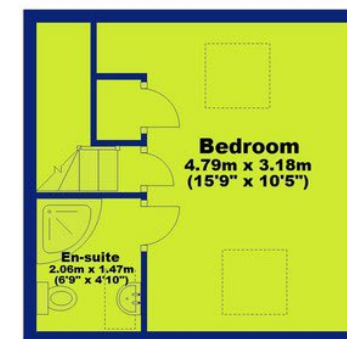

Total area: approx. 133.3 sq. metres (1434.3 sq. feet)



0115 841 1155



Location



Gallery



Video



Contact

93 Ella Road, [West Bridgford, Nottingham, NG2 5GZ](#)



Interested in this home?

Contact the FHP Living Team on 0115 841 1155

23 Bridgford Road
West Bridgford
Nottingham
NG2 6AU

1 Weekday Cross
The Lace Market
Nottingham
NG1 2GB

Score	Energy rating	Current	Potential
92+	A		
81-91	B		
69-80	C		73 C
55-68	D		
39-54	E	45 E	
21-38	F		
1-20	G		

These sales particulars have been prepared by FHP Living on the instruction of the vendor. Services, equipment and fittings mentioned in these particulars have NOT been tested, and as such, no warranties can be given. Prospective purchasers are advised to make their own enquiries regarding such matters. These sales particulars are produced in good faith and are not intended to form part of a contract. Whilst FHP Living have taken care in obtaining internal measurements, they should only be regarded as approximate.

Purchaser information - Under the Protecting Against Money Laundering and the Proceeds of Crime Act 2002, FHP Living require any successful purchasers proceeding with a purchase to provide two forms of identification i.e. passport or photocard driving license and a recent utility bill. This evidence will be required prior to FHP Living instructing solicitors in the purchase or the sale of a property.