

# 8 Firmin Way

Wilford  
Nottingham  
NG11 7HN

**Guide Price £565,000**



Click for further information:-



Location



Gallery



Video



Contact



0115 841 1155



- Four-bedroom detached new home
- Family bathroom, en-suite and downstairs WC
- Open plan living kitchen
- Accommodation across three floors
- Benefitting from Solar Panels and 10 year Premier Guarantee
- Close to local amenities and the Tram Stop
- Off road parking
- Viewing essential!
- Contact us for more information!
- Tenure - Freehold



0115 841 1155



Location



Gallery



Video



Contact

8 Firmin Way, , Nottingham, NG11 7HN

## Key Features

Phase 2, Firmin Way – Stunning New Homes Await!

Welcome to the exciting Phase 2 development at Firmin Way, Wilford – beautifully designed homes, ready for you to move straight into!

Nestled in the desirable Wilford area, with excellent amenities and just a short stroll to the tram stop, making commuting effortless. The homes benefit from solar panels, helping to reduce energy costs while being environmentally friendly. The property also comes with a 10-year Premier Guarantee, ensuring quality and security in your new home.

Plot 2.1 – A four-bedroom detached home.

As you enter, you're welcomed by a spacious hallway leading to a bright and stylish living room and a stunning open-plan kitchen/dining area, complete with modern appliances. You'll also find a downstairs WC and a practical utility room for added convenience.

The first floor offers three well-proportioned bedrooms and a luxurious four-piece family bathroom.

The second floor boasts a private master suite, featuring a modern en-suite shower room.

Enjoy off-road parking to the front and a private rear garden, ideal for outdoor entertaining or relaxation.

This modern, energy-efficient new home is perfect for growing families or professionals seeking a stylish and convenient lifestyle. Don't miss out – book your viewing today!

Please note - the advertisement photos are of number 23 and not 8.





0115 841 1155



Location



Gallery



Video



Contact

8 Firmin Way, , Nottingham, NG11 7HN

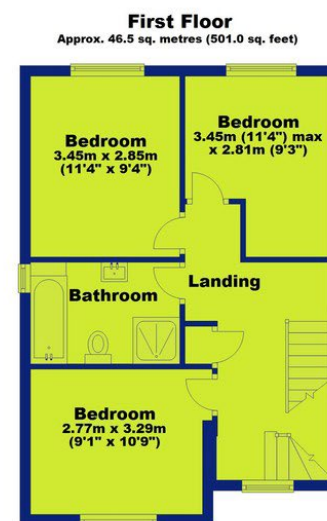
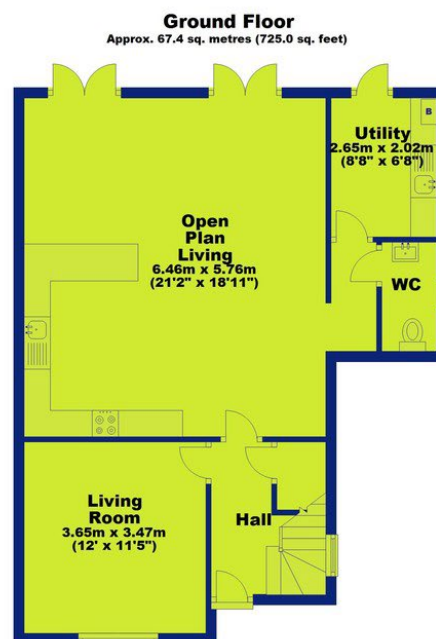

**Total area: approx. 146.4 sq. metres (1575.7 sq. feet)**



0115 841 1155



Location



Gallery



Video



Contact



8 Firmin Way, , Nottingham, NG11 7HN



## *Interested in this home?*

Contact the FHP Living Team on 0115 841 1155

23 Bridgford Road  
West Bridgford  
Nottingham  
NG2 6AU

1 Weekday Cross  
The Lace Market  
Nottingham  
NG1 2GB

These sales particulars have been prepared by FHP Living on the instruction of the vendor. Services, equipment and fittings mentioned in these particulars have NOT been tested, and as such, no warranties can be given. Prospective purchasers are advised to make their own enquiries regarding such matters. These sales particulars are produced in good faith and are not intended to form part of a contract. Whilst FHP Living have taken care in obtaining internal measurements, they should only be regarded as approximate.

Purchaser information - Under the Protecting Against Money Laundering and the Proceeds of Crime Act 2002, FHP Living require any successful purchasers proceeding with a purchase to provide two forms of identification i.e. passport or photocard driving license and a recent utility bill. This evidence will be required prior to FHP Living instructing solicitors in the purchase or the sale of a property.