

22 Furness Close

West Bridgford
Nottingham
NG2 6LR

Offers over £290,000



Click for further information:-



Location



Gallery



Video



Contact



0115 841 1155



- No upward chain! Ready to move straight into
- Three-bedroom mid-terraced home
- Open plan kitchen diner
- Three-piece family bathroom
- South-West facing rear garden
- Sought-after West Bridgford location
- Highly regarded school catchment area
- Viewing essential!
- Council Tax Band - B
- Tenure - Freehold



0115 841 1155



Location



Gallery



Video



Contact

22 Furness Close, West Bridgford, Nottingham, NG2 6LR

Key Features

Being sold with no upward chain, this conveniently positioned three-bedroom townhouse offers an excellent opportunity for down sizers, first-time buyers, or families seeking access to highly sought-after school catchments in the desirable suburb of West Bridgford. Perfect for fast movers, the property provides well-maintained accommodation that is ready to move into, complemented by a private, south-facing garden ideal for enjoying the sun after a long day.

The property is entered through a UPVC double-glazed front door, leading to a reception porch with quarry tile flooring, shelving, and a second door opening into the hallway. The hallway features wood laminate flooring, a contemporary column radiator, a cupboard housing the electrical consumer unit, cloak storage space under the stairs, and an open-plan archway to the living room.

The living room continues the wood laminate flooring, with a double-glazed bay window offering delightful views over fields to the front. Additional features include a column radiator, a storage cupboard, and a door leading to the dining kitchen.

The dining kitchen is fitted with a range of contemporary shaker-style wall and base units, integrated appliances, and a double-glazed window alongside patio doors that open to the south-facing decked area. The kitchen is finished with herringbone laminate flooring, a column radiator, spotlights, and a useful storage cupboard.

On the first floor, the landing provides loft access to a roof cupboard housing the boiler and immersion heater, a further storage cupboard, and doors to three bedrooms and a contemporary family bathroom. The bathroom features a modern three-piece suite, an electric shower over the bath with a glass shower screen, and an opaque window to the rear.

Outside, the front garden is enclosed by a two-bar fence with a paved pathway leading to the front door, alongside a lawned area. The property enjoys an open aspect to the front, overlooking fields and a play area in the distance.

The rear garden boasts a southerly aspect, making it the perfect spot for relaxing in the evening sun. It includes a decked area, a lawn, and a pathway leading to the rear, where there is a built-in shed and a secure concrete storage area with power and lighting.

This charming property combines convenience, comfort, and a fantastic location, making it ideal for those looking to settle in this sought-after area.





0115 841 1155



Location



Gallery



Video



Contact

22 Furness Close, [West Bridgford, Nottingham, NG2 6LR](#)



Ground Floor

Approx. 41.3 sq. metres (444.4 sq. feet)



First Floor

Approx. 40.1 sq. metres (431.1 sq. feet)

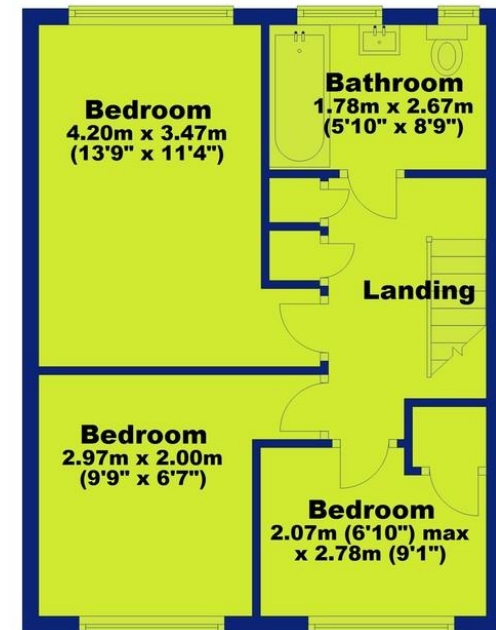

Total area: approx. 81.3 sq. metres (875.6 sq. feet)



0115 841 1155



Location



Gallery



Video



Contact

22 Furness Close, [West Bridgford, Nottingham, NG2 6LR](#)



Interested in this home?

Contact the FHP Living Team on 0115 841 1155

23 Bridgford Road
West Bridgford
Nottingham
NG2 6AU

1 Weekday Cross
The Lace Market
Nottingham
NG1 2GB

Score	Energy rating	Current	Potential
92+	A		
81-91	B		88 B
69-80	C	75 C	
55-68	D		
39-54	E		
21-38	F		
1-20	G		

These sales particulars have been prepared by FHP Living on the instruction of the vendor. Services, equipment and fittings mentioned in these particulars have NOT been tested, and as such, no warranties can be given. Prospective purchasers are advised to make their own enquiries regarding such matters. These sales particulars are produced in good faith and are not intended to form part of a contract. Whilst FHP Living have taken care in obtaining internal measurements, they should only be regarded as approximate.

Purchaser information - Under the Protecting Against Money Laundering and the Proceeds of Crime Act 2002, FHP Living require any successful purchasers proceeding with a purchase to provide two forms of identification i.e. passport or photocard driving license and a recent utility bill. This evidence will be required prior to FHP Living instructing solicitors in the purchase or the sale of a property.