

Regency Point,
Radcliffe Road
West Bridgford
Nottingham
NG2 5HG

Guide Price £250,000



Click for further information:-



Location



Gallery



Video



Contact



0115 841 1155



- Two-bedroom second floor apartment
- Family bathroom and en-suite
- Open plan kitchen living area
- Allocated gated parking
- Close to all local amenities
- Sought-after West Bridgford location
- Viewing essential!
- Council Tax Band - C
- Service Charge - £1,977.28 PA
- Tenure - Leasehold - 107 Years Remaining



Radcliffe Road, [West Bridgford, Nottingham, NG2 5HG](#)

Key Features

A two-bedroom, second floor apartment located in the sought-after area of West Bridgford. This stylish apartment boasts intercom/keypad access, ensuring both convenience and security, while the gated parking-with your very own allocated space-adds a layer of exclusivity.

Step inside to be greeted by a spacious hallway that seamlessly connects to every corner of the apartment, with doors leading to two bedrooms, a contemporary main bathroom, and open plan living kitchen space. This vibrant heart of the home is great for entertaining, featuring dedicated zones for dining and relaxation. The sleek kitchen, equipped with integrated appliances, exudes modern elegance, while expansive windows bathe the room in natural light, creating an ambiance that's both warm and welcoming.

The Master bedroom is complete with built-in wardrobes for impeccable storage and a three-piece shower room.

A short walk from the apartment is the bustling Central Avenue, with restaurants, coffee shops, bars, and boutiques. For sports enthusiasts, the proximity to Nottingham Cricket Ground, Nottingham Forest Ground, and Notts County is simply unbeatable.

Welcome to a lifestyle of comfort, convenience, and contemporary charm.



0115 841 1155



Location



Gallery



Video



Contact

Radcliffe Road, West Bridgford, Nottingham, NG2 5HG

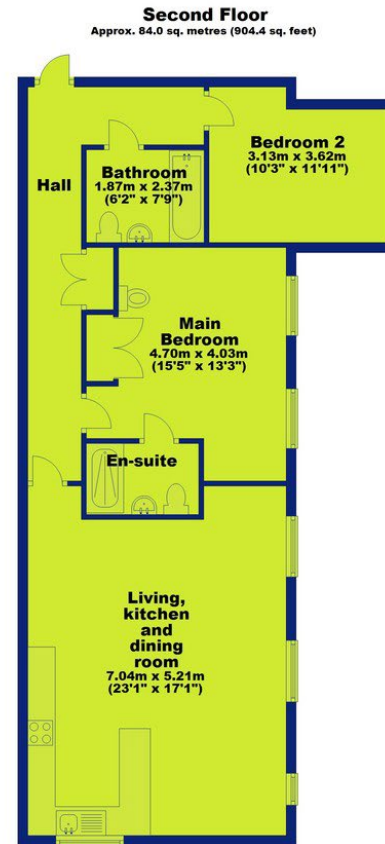

Total area: approx. 84.0 sq. metres (904.4 sq. feet)

0115 841 1155

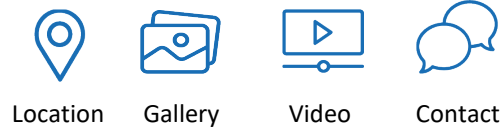

Radcliffe Road, West Bridgford, Nottingham, NG2 5HG



Interested in this home?

Contact the FHP Living Team on 0115 841 1155

23 Bridgford Road
West Bridgford
Nottingham
NG2 6AU

1 Weekday Cross
The Lace Market
Nottingham
NG1 2GB

Score	Energy rating	Current	Potential
92+	A		
81-91	B	81 B	83 B
69-80	C		
55-68	D		
39-54	E		
21-38	F		
1-20	G		

These sales particulars have been prepared by FHP Living on the instruction of the vendor. Services, equipment and fittings mentioned in these particulars have NOT been tested, and as such, no warranties can be given. Prospective purchasers are advised to make their own enquiries regarding such matters. These sales particulars are produced in good faith and are not intended to form part of a contract. Whilst FHP Living have taken care in obtaining internal measurements, they should only be regarded as approximate.

Purchaser information - Under the Protecting Against Money Laundering and the Proceeds of Crime Act 2002, FHP Living require any successful purchasers proceeding with a purchase to provide two forms of identification i.e. passport or photocard driving license and a recent utility bill. This evidence will be required prior to FHP Living instructing solicitors in the purchase or the sale of a property.