

Penthouse, Riverside, Wilford Lane

West Bridgford
Nottingham
NG2 7ZZ

Guide Price £585,000



Click for further information:-



Location



Gallery



Video



Contact



0115 841 1155



- Luxury three-bedroom penthouse apartment
- Main bathroom and two en-suites
- Open plan kitchen living area
- Spacious balcony
- High specification throughout
- Two allocated parking spaces
- Electric car charging available
- Service Charge - £2042.11 PA
- Council Tax Band - D
- Tenure - Leasehold - 249 years remaining

0115 841 1155



Location



Gallery



Video



Contact

 fhp.living
fhpliving.co.uk

Penthouse, Wilford Lane, West Bridgford, Nottingham, NG2 7ZZ

Key Features

A luxurious and spacious three double bedroom Penthouse apartment on the third floor of Riverside 2.

The apartment is situated at the stunning tree-lined entrance to the development.

The accommodation comprises of open plan living/kitchen/dining area with floor to ceiling patio doors offering stunning views over the Wilford hillside. The Penthouse boasts three double bedrooms, two of which have en-suite shower rooms and the third bedroom being situated next to the family bathroom, with shower over. The master bedroom also benefits from a walk-in wardrobe.

Riverside, situated within Nottingham's prime location of West Bridgford, offers you the best of both worlds – the eclectic choice of West Bridgford's restaurants, cafes and bars, with the vibrant Nottingham City close at hand, alongside the calming influence of the flowing River Trent providing beautiful views and delightful riverside walks.

The apartment has a high quality specification throughout which includes:

- Mackintosh fitted kitchen
- Bosch oven and induction hob
- Porcelanosa sanitaryware and tiling
- Quick-Step flooring
- Brushed chrome sockets
- Virgin, BT & Sky available
- 10 year warranty with Premier
- Dishwasher

West Bridgford is one of Nottingham's most desirable locations, with excellent transport links, including buses and trams, providing easy access to the city centre and from there a 90 minute train ride away from London. There is a multitude of cafes, restaurants and bars creating a vibrant feel.



0115 841 1155



Location



Gallery



Video



Contact

Penthouse, Wilford Lane, West Bridgford, Nottingham, NG2 7ZZ



Top floor
Approx. 123.9 sq. metres (1333.6 sq. feet)

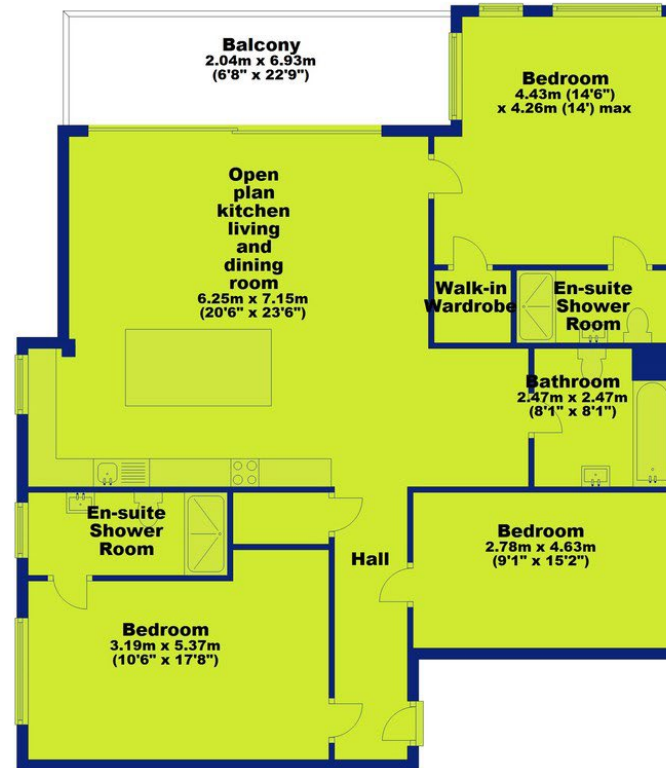

Total area: approx. 123.9 sq. metres (1333.6 sq. feet)

0115 841 1155

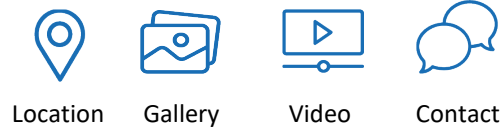

Penthouse, Wilford Lane, West Bridgford, Nottingham, NG2 7ZZ

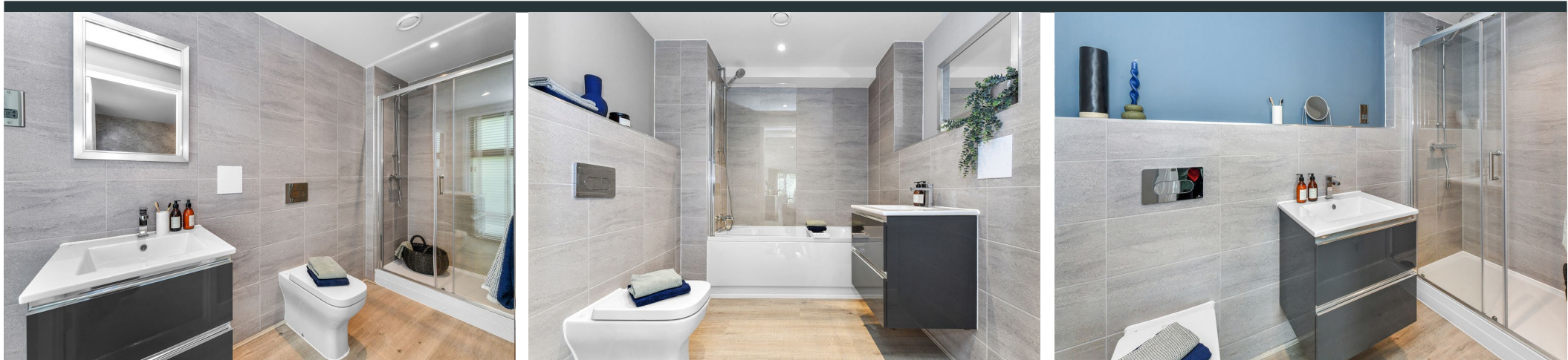

Interested in this home?

Contact the FHP Living Team on 0115 841 1155

23 Bridgford Road
West Bridgford
Nottingham
NG2 6AU

1 Weekday Cross
The Lace Market
Nottingham
NG1 2GB

| Score | Energy rating | Current | Potential |
|-------|---------------|---------|-----------|
| 92+ | A | | |
| 81-91 | B | | |
| 69-80 | C | 70 C | 70 C |
| 55-68 | D | | |
| 39-54 | E | | |
| 21-38 | F | | |
| 1-20 | G | | |

These sales particulars have been prepared by FHP Living on the instruction of the vendor. Services, equipment and fittings mentioned in these particulars have NOT been tested, and as such, no warranties can be given. Prospective purchasers are advised to make their own enquiries regarding such matters. These sales particulars are produced in good faith and are not intended to form part of a contract. Whilst FHP Living have taken care in obtaining internal measurements, they should only be regarded as approximate.

Purchaser information - Under the Protecting Against Money Laundering and the Proceeds of Crime Act 2002, FHP Living require any successful purchasers proceeding with a purchase to provide two forms of identification i.e. passport or photocard driving license and a recent utility bill. This evidence will be required prior to FHP Living instructing solicitors in the purchase or the sale of a property.