

5 Rectory Road

West Bridgford,
Nottingham,
NG2 6BE

Offers in Excess of £650,000



Click for further information:-



Location



Gallery



Video



Contact



0115 841 1155



- Five-bedroom semi-detached home
- Family bathroom and en-suite
- Open plan kitchen diner
- Two reception rooms
- 80ft rear garden
- Sought-after central West Bridgford location
- Highly regarded school catchment area
- Viewing essential
- Council Tax Band - D
- Tenure - Freehold



0115 841 1155



Location



Gallery



Video



Contact

5 Rectory Road, [West Bridgford, Nottingham, NG2 6BE](#)

Key Features

A stunning bay-fronted period property situated in the heart of the highly desirable Nottingham suburb of West Bridgford. Boasting over 1,900 square feet of living space, sought-after school catchments, and just a short stroll from the cafes, bars, and restaurants of Central Avenue. With off-street parking and an approximate 80-foot rear garden, this property offers an exceptional family home in a conveniently central location.

Upon entering the property, you are greeted by an arched period porch leading to a spacious reception hall with period-style features including a decorative ceiling, coving, and flooring. The hall leads to the lounge, featuring a charming double-glazed bay window with built-in shutter blinds, a period-style fireplace with cast-iron and Nuvo insert, and a skillfully installed range of bookshelves. Additionally, there is a family room with double-glazed bay windows allowing ample natural light, a gas fireplace set upon a stone hearth, and original picture and coving details. The kitchen has painted wood shaker style units, with a butcher block worktop, Belfast sink and integrated appliances, overlooking the dining area. It also boasts a dual aspect with bifold doors opening onto the 80-foot garden, offering a delightful space for dining and entertaining.

The first floor comprises three generous bedrooms, with the main bedroom featuring built-in wardrobes and an en-suite shower room. The family bathroom offers a contemporary four-piece suite.

The second floor landing provides access to further bedrooms with Velux windows, built-in wardrobes, and eaves storage spaces.

Outside, the front of the property features a walled boundary and a blocked edge driveway providing parking and access to the rear garden. The rear garden includes a large patio area, a courtyard adjacent to the kitchen, and a spacious lawn with shrub borders and a shed. The garden extends approximately 80 feet, offering sun throughout the day.





0115 841 1155



Location



Gallery



Video



Contact

5 Rectory Road, West Bridgford, Nottingham, NG2 6BE

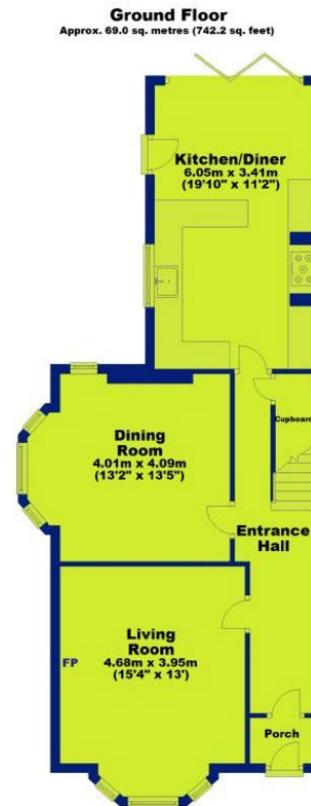

Total area: approx. 177.8 sq. metres (1914.3 sq. feet)



0115 841 1155



Location



Gallery



Video



Contact

5 Rectory Road, [West Bridgford, Nottingham, NG2 6BE](#)



Interested in this home?

Contact the FHP Living Team on 0115 841 1155

23 Bridgford Road
West Bridgford
Nottingham
NG2 6AU

1 Weekday Cross
The Lace Market
Nottingham
NG1 2GB

Score	Energy rating	Current	Potential
92+	A		
81-91	B		82 B
69-80	C		
55-68	D	68 D	
39-54	E		
21-38	F		
1-20	G		

These sales particulars have been prepared by FHP Living on the instruction of the vendor. Services, equipment and fittings mentioned in these particulars have NOT been tested, and as such, no warranties can be given. Prospective purchasers are advised to make their own enquiries regarding such matters. These sales particulars are produced in good faith and are not intended to form part of a contract. Whilst FHP Living have taken care in obtaining internal measurements, they should only be regarded as approximate.

Purchaser information - Under the Protecting Against Money Laundering and the Proceeds of Crime Act 2002, FHP Living require any successful purchasers proceeding with a purchase to provide two forms of identification i.e. passport or photocard driving license and a recent utility bill. This evidence will be required prior to FHP Living instructing solicitors in the purchase or the sale of a property.