

Apartment 2, Bridgford Place

West Bridgford Nottingham
NG2 6BF

Offers In Excess Of £250,000



[Click for further information:-](#)



Location



Gallery



Video



Contact



0115 841 1155



- Two-bedroom ground floor apartment
- High-spec bathroom and en-suite shower room
- Open plan lounge, diner and kitchen
- Intercom entrance system
- Perfect for first time buyers, down sizers or investors
- Close to local transport links
- Located in central West Bridgford
- Viewing essential
- Council Tax Band - C
- Tenure - Leasehold

0115 841 1155



Location



Gallery



Video



Contact

 fhp.living
fhpliving.co.uk

Apartment 2, Bridgford Place, West Bridgford, Nottingham, NG2 6BF

Key Features

A perfect first time buy or ideal for downsize buyers looking for a ground floor apartment, which is situated in central West Bridgford and on the doorstep of the coffee bars and restaurants on Central Avenue. The apartment is immaculately presented throughout, offering two bedrooms and spacious accommodation. An early viewing is recommended!

You enter the property through an intercom entrance system with an entrance hallway with post boxes and further door opening into an internal hall, which gives access to the front door. On entering the apartment, you are met by a generous hallway with space for storage and furniture, which leads through to a light and bright lounge/dining room and kitchen area with a range of contemporary wall and base units with Quartz worktops and integrated Bosch and Indesit appliances. Dual aspect windows to the side and rear elevation provide an ideal place to relax at the end of a long day.

There are two double bedrooms, with the master bedroom having a high specification three-piece en-suite shower room and there is a main bathroom, which again is finished to a high specification, with ceramic porcelain tiled walls and floors, and both with heated towel rails. There is a further storage room and boiler cupboard which offers excellent extra storage. The apartment boasts underfloor heating throughout, controlled by room-by-room thermostats.

Outside there are communal garden areas and easy access to West Bridgford Town Centre. There is a Service Charge of £626.58 every 6 months.



0115 841 1155



Location



Gallery



Video



Contact

Apartment2, Bridgford Place West Bridgford, Nottingham, NG2 6BF



Ground Floor
Approx. 63.1 sq. metres (678.8 sq. feet)

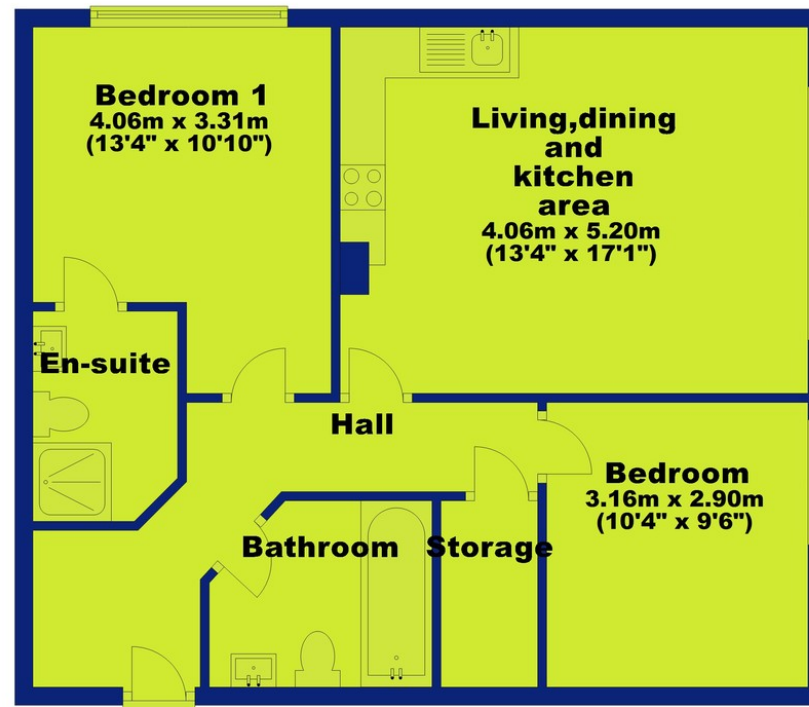

Total area: approx. 63.1 sq. metres (678.8 sq. feet)

0115 841 1155

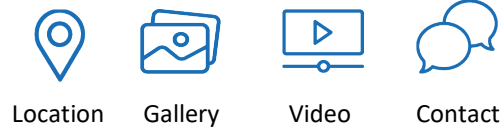

Apartment 2, Bridgford Place West Bridgford, Nottingham, NG2 6BF



Interested in this home?

Contact the FHP Living Team on 0115 841 1155

23 Bridgford Road
West Bridgford
Nottingham
NG2 6AU

1 Weekday Cross
The Lace Market
Nottingham
NG1 2GB

Score	Energy rating	Current	Potential
92+	A		
81-91	B		
69-80	C	75 C	75 C
55-68	D		
39-54	E		
21-38	F		

These sales particulars have been prepared by FHP Living on the instruction of the vendor. Services, equipment and fittings mentioned in these particulars have NOT been tested, and as such, no warranties can be given. Prospective purchasers are advised to make their own enquiries regarding such matters. These sales particulars are produced in good faith and are not intended to form part of a contract. Whilst FHP Living have taken care in obtaining internal measurements, they should only be regarded as approximate.

Purchaser information - Under the Protecting Against Money Laundering and the Proceeds of Crime Act 2002, FHP Living require any successful purchasers proceeding with a purchase to provide two forms of identification i.e. passport or photocard driving license and a recent utility bill. This evidence will be required prior to FHP Living instructing solicitors in the purchase or the sale of a property.