



32 Greenfield Road, Bristol, BS31 1FL

Offers Over £215,000

Nestled on Greenfield Road within the desirable Meadows development, this charming first-floor apartment presents an excellent opportunity for both first-time buyers and investors alike. Spanning a comfortable 560 square feet, the property boasts two well-proportioned bedrooms and a modern bathroom, ensuring ample space for relaxation and convenience.

The heart of the home features an inviting open-plan living/kitchen area, enhanced by a southerly facing aspect that floods the space with natural light. A delightful Juliet balcony offers a perfect spot to enjoy the fresh air and views. The contemporary kitchen is equipped with integrated appliances, making it a joy for culinary enthusiasts.

Constructed in 2014, this apartment benefits from uPVC double glazing, ensuring energy efficiency and a peaceful living environment. Residents will also appreciate the communal bin and bike store, promoting a tidy and practical lifestyle. Additionally, the property includes an allocated parking space, a valuable asset in this bustling area.

Conveniently located near Keynsham High Street, you will find a variety of local shops and amenities just a short stroll away. An internal inspection is highly recommended to fully appreciate the quality and appeal of this well-presented apartment. Don't miss the chance to make this delightful property your new home or investment.

Entrance via front door into

Hallway

Wood flooring, airing cupboard housing hot water tank with shelving for linen, doors to

Bathroom

7'9" x 5'2" (2.38 x 1.60)



Suite comprising low level Roca w/c, wash hand basin, paneled bath with hinged glazed shower screen and electric shower over, tiled bath area, wood effect flooring, chrome heated towel rail, light and extractor.

Open Plan Lounge/Kitchen

14'4" x 19'3" (4.38 x 5.87)



uPVC double glazed French doors to Juliette balcony enjoying lovely views, wood flooring, uPVC double glazed window to side aspect, electric wall mounted heater, area for bar stools on edge of kitchen, a range of wall and floor units with worksurface over, 1 1/4 bowl stainless steel sink drainer unit with mixer taps over, tiled splash backs, 4 ring Electrolux electric hob with electric oven and grill beneath and extractor over, under unit lighting, built in full sized Hotpoint dishwasher, integrated washing machine, space for freestanding fridge freezer, extractor.

Master Bedroom

8'2" x 13'4" (2.49 x 4.08)



uPVC double glazed window to front aspect, wood effect flooring, space for freestanding wardrobes and bedroom furniture.

Bedroom Two

7'6" x 8'6" (2.31 x 2.61)



uPVC double glazed window to front aspect, wood effect flooring.

Directions

Sat Nav BS31 1FL

Floor Plan

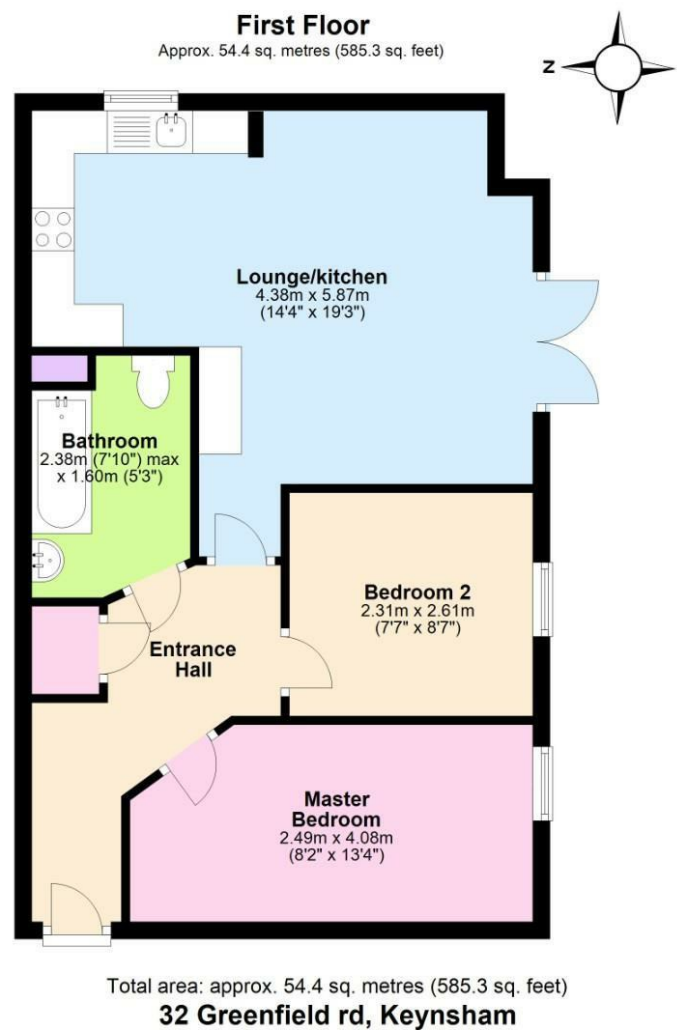

Area Map

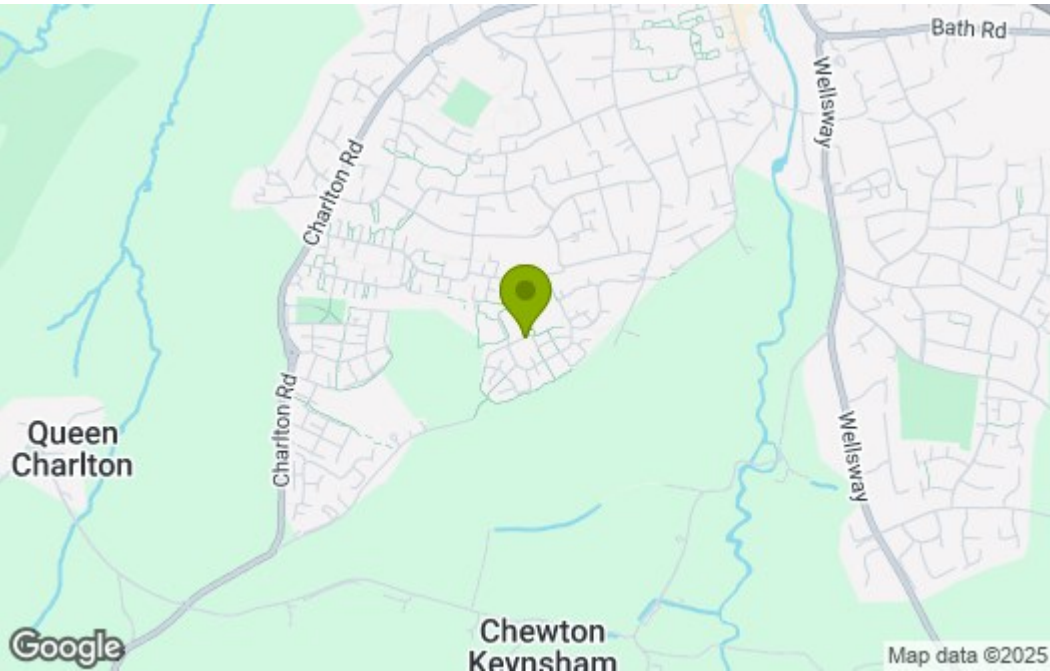

Energy Efficiency Graph

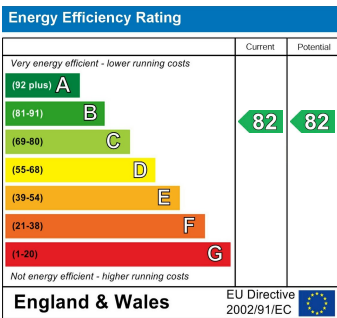

These particulars, whilst believed to be accurate are set out as a general outline only for guidance and do not constitute any part of an offer or contract. Intending purchasers should not rely on them as statements of representation of fact, but must satisfy themselves by inspection or otherwise as to their accuracy. No person in this firms employment has the authority to make or give any representation or warranty in respect of the property.