

**118 Bifield Road, Bristol, BS14 8TU****£130,000**

A neatly presented top floor flat. The accommodation comprises, private entrance, entrance hall, sitting / dining room, fitted kitchen, one double bedroom and a bathroom with shower over the bath. The property also benefits having a single garage in a nearby block. Offered with no onward chain call Eveleighs to arrange your early internal viewing.

Private Entrance

Entrance Hall

Sitting / Dining Room

15'6" x 12'1" (4.73 x 3.69)



Kitchen

6'1" x 6'11" (1.87 x 2.12)



Bedroom

12'2" x 11'9" (3.73 x 3.60)



Bathroom

5'5" x 5'10" (1.67 x 1.78)

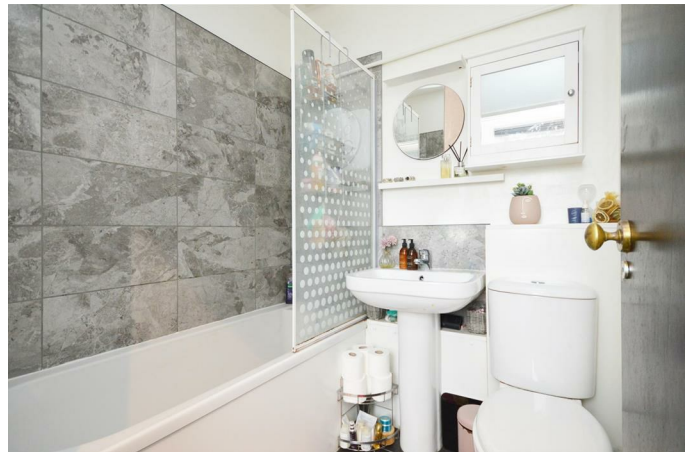

Garage



Floor Plan

First Floor

Approx. 52.9 sq. metres (569.4 sq. feet)

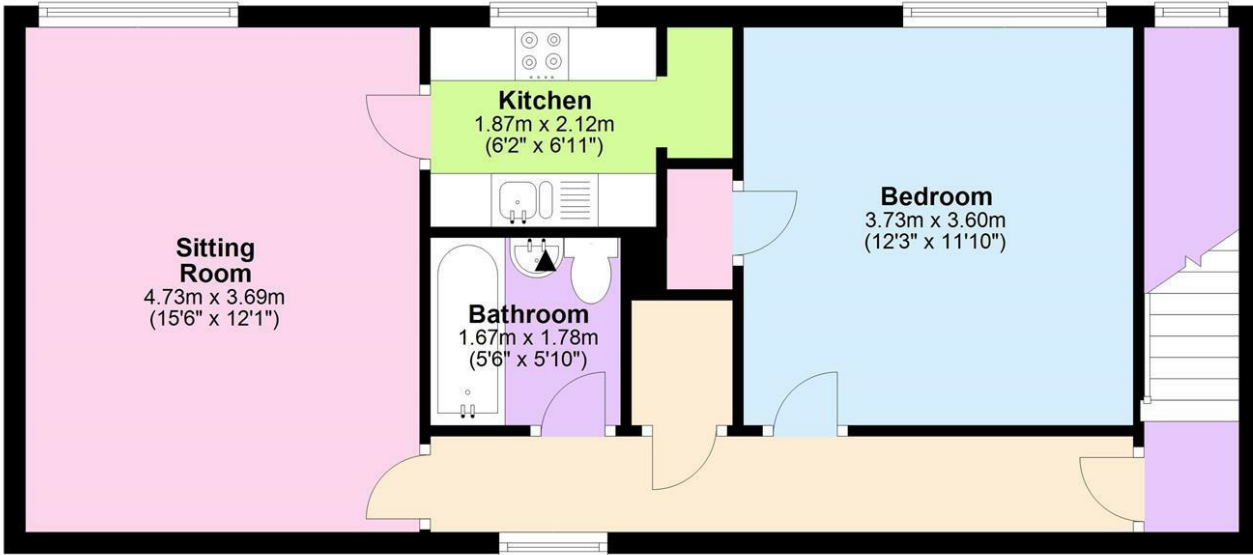

Total area: approx. 52.9 sq. metres (569.4 sq. feet)

Area Map

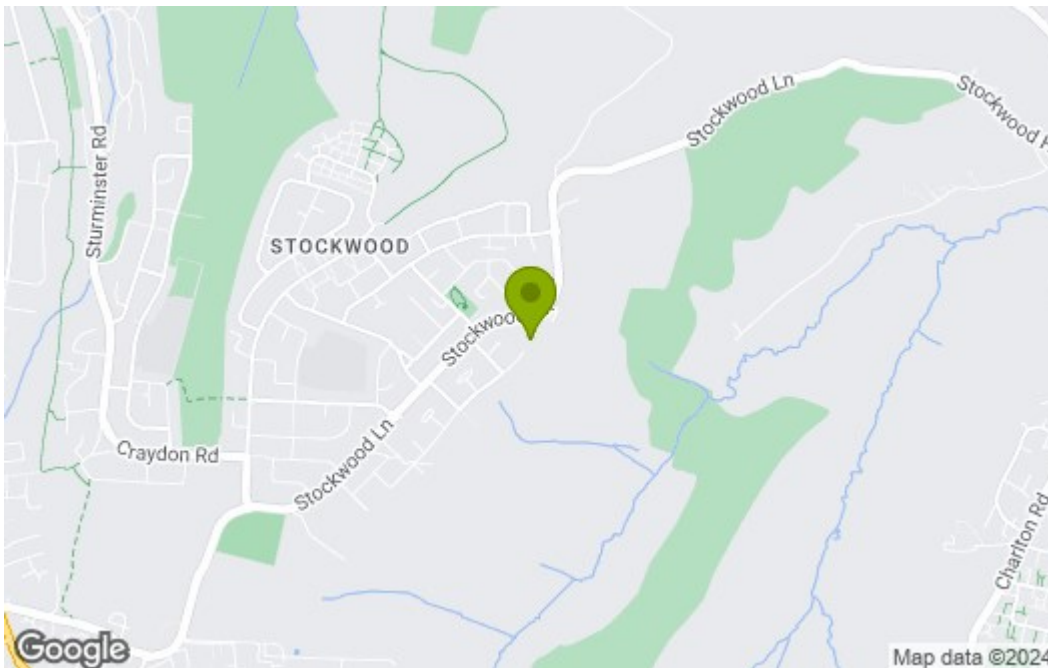

Energy Efficiency Graph

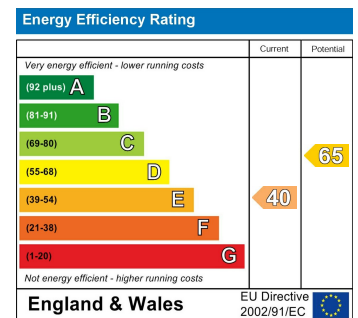

These particulars, whilst believed to be accurate are set out as a general outline only for guidance and do not constitute any part of an offer or contract. Intending purchasers should not rely on them as statements of representation of fact, but must satisfy themselves by inspection or otherwise as to their accuracy. No person in this firm's employment has the authority to make or give any representation or warranty in respect of the property.