



44 Clwyd Gardens, Kinmel Bay - LL18 5NB

£135,000 Freehold

Available with no chain: a two-bedroom detached bungalow in a sought-after location near the seafront. Includes driveway parking.

SIMPLY ESTATES



Porch

4' 1" x 9' 1" (1.24m x 2.77m)

Discover the inviting front UPVC porch featuring a UPVC door, complemented by grey carpets and tasteful neutral decor.

Main Bedroom

7' 5" x 8' 8" (2.27m x 2.65m)

Situated at the front of the property, this bedroom enjoys plenty of natural light from its window overlooking the porch. It is fitted with grey carpets and neutrally decorated, ensuring a bright and welcoming space.

Bedroom Two

5' 8" x 8' 10" (1.72m x 2.69m)

The second bedroom is a smaller single room, perfect as an office space or for young children. Recently painted in neutral tones and fitted with new grey carpets, it features a rear window with views of the back garden area.



Kitchen

9' 6" x 8' 0" (2.89m x 2.45m)

The fully functioning kitchen is neutrally decorated and includes both lower and overhead cabinets, along with an electric cooker. It provides ample space for a small table. The boiler is discreetly housed in a cupboard and also comprises of a small pantry space on entering the room. The kitchen benefits from ample natural light, with a front-facing window and a small side window.



Lounge

9' 5" x 12' 6" (2.88m x 3.81m)

At the heart of the bungalow, the lounge is situated just off the entrance hall. It features a rear-facing window and has been recently replastered, neutrally decorated, and fitted with new carpets.

Bathroom

5' 10" x 6' 6" (1.77m x 1.98m)

The family bathroom, located in the extended section of the bungalow, features a white three-piece suite, complemented by white and blue tiled walls and modern laminate-effect vinyl flooring.

Garden

The garden is made private with fencing and a newly fitted side gate. It consists of gravel and decking areas, providing a versatile outdoor space.



Approx Gross Internal Area
43 sq m / 460 sq ft

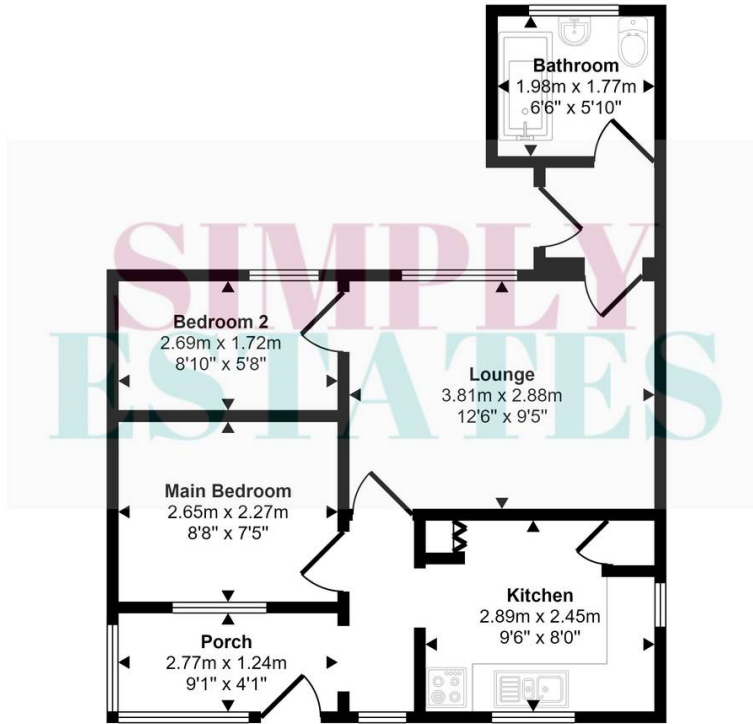

Floorplan

This floorplan is only for illustrative purposes and is not to scale. Measurements of rooms, doors, windows, and any items are approximate and no responsibility is taken for any error, omission or mis-statement. Icons of items such as bathroom suites are representations only and may not look like the real items. Made with Made Snappy 360.

Discover the Simply Estates Advantage!

Are you looking to sell your property? At Simply Estates, we offer a personalised, family-run service with a commission rate of just 0.9% and no VAT. Experience the difference with our dedicated team.

Contact us today on 01745 590919 or Rhuddlan@simplyestates.co.uk



SIMPLY ESTATES