



CLAVERTON STREET
PIMLICO

JACKSON-STOPS 

CLAVERTON STREET, PIMLICO, SW1V

ASKING PRICE: £500,000

A second floor, one bedroom apartment is offered to the market in Pimlico, SW1.

The property consists of an open plan kitchen reception, benefiting from plenty of natural light and good ceiling height with the bedroom quietly situated at the rear. Offered with no onward chain & a recent lease extension. There is also a separate, demised utility room providing extra storage. This would suit all those looking for a first time buy in central London, pied-a-terre or buy to let investment. Claverton St is a short walk from Pimlico Underground (0.3 miles), Victoria mainline station is also only 0.8 miles away, as well as the Gatwick Express. Nearby are the pretty areas of St George's Square and Battersea Park and there are many local boutiques and restaurants on Moreton Street and Churton Street.

KEY FEATURES

- Leasehold: 146 Yrs Left
- One Bedroom
- No Onward Chain
- Service Charge: £1365
- Sole Agent
- Pimlico

Energy Rating: D. We aim to make our particulars both accurate and reliable. However they are not guaranteed; nor do they form part of an offer or contract. If you require clarification on any points then please contact us, especially if you are travelling some distance to view. Please note that appliances and heating systems have not been tested and therefore no warranties can be given as to their good working order.

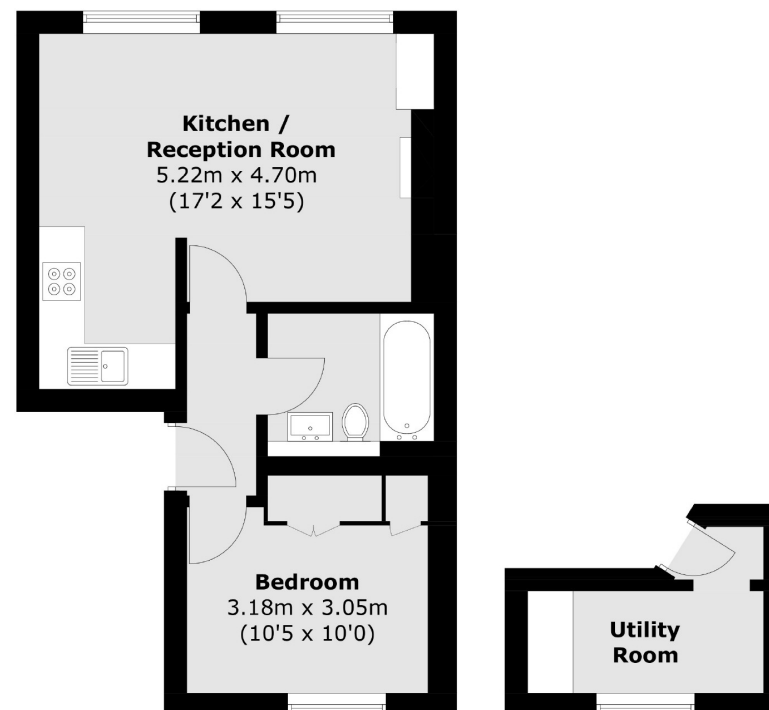

Second Floor

(Not Shown In Actual
Location / Orientation)

Total area (approx.): 37.8sq. m (406.9 sq. ft)

Utility Room : 5.2 sq. m (56.0 sq. ft)

ASKING PRICE: £500,000

PIMLICO

020 7828 4050

pimlicosales@jackson-stops.com

jackson-stops.co.uk

JACKSON-STOPS

