



REGENCY STREET
LONDON

JACKSON-STOPS 

REGENCY STREET, LONDON, SW1P

ASKING PRICE: £350,000

A lovely first floor studio' apartment is presented to the market within this smart redbrick period mansion block in Westminster, SW1.

Norfolk House is located on the corner of Regency Street and Page Street near Vincent Square and therefore provides easy access to all the bars, shops and restaurants the Horseferry Road and Victoria Street have to offer. This would make an excellent first time buy, rental investment or central London pied-a-terre. The Houses of Parliament, Tate Britain, Cardinal Place shopping centre, Nova development and the River Thames are all within walking distance. Transport is provided by Pimlico Underground station, St James's Underground Station and Victoria mainline and Underground stations (including the Gatwick Express).

KEY FEATURES

- Studio
- Mansion Block
- Leasehold: 173 Years
- Service Charge: £905 pa
- No Onward Chain
- Sole Agent

Energy Rating: C. We aim to make our particulars both accurate and reliable. However they are not guaranteed; nor do they form part of an offer or contract. If you require clarification on any points then please contact us, especially if you are travelling some distance to view. Please note that appliances and heating systems have not been tested and therefore no warranties can be given as to their good working order.

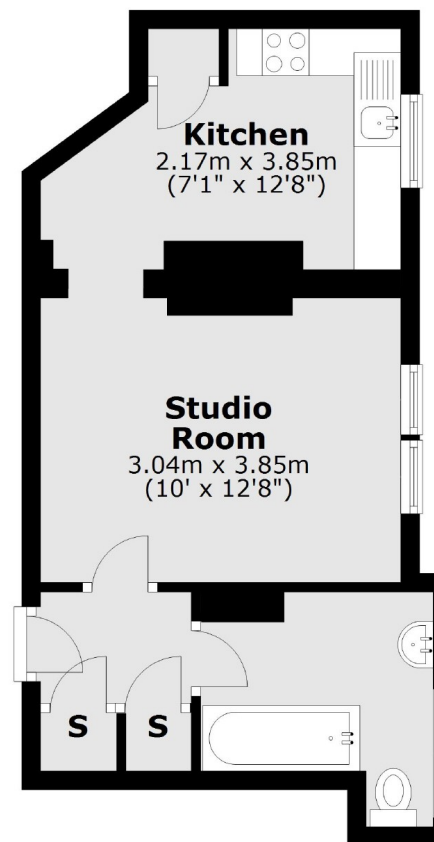

First Floor

Total area: approx. 30.2 sq. metres (325.5 sq. feet)

ASKING PRICE: £350,000

PIMLICO

020 7828 4050

pimlicosales@jackson-stops.com

jackson-stops.co.uk

JACKSON-STOPS