



WINCHESTER STREET  
PIMLICO

JACKSON-STOPS 

## WINCHESTER STREET, PIMLICO, SW1V

ASKING PRICE: £635,000

A first-floor two-bedroom apartment is offered to the market with no onward chain in Pimlico, SW1.

This wonderfully bright, triple-aspect apartment would make either an ideal first home in prime Central London, a well-appointed and conveniently located pied-à-terre or long term buy to let investment.

Winchester Street is situated in the heart of the ever popular Pimlico Grid, only 0.4 miles from Victoria Mainline station with Gatwick Express services, only 0.7 miles from Sloane Square; the gateway to the famous Kings Road SW3 with its world class cuisine and boutique shopping and only 0.7 miles from the 200 acres of open space that Battersea Park has to offer.

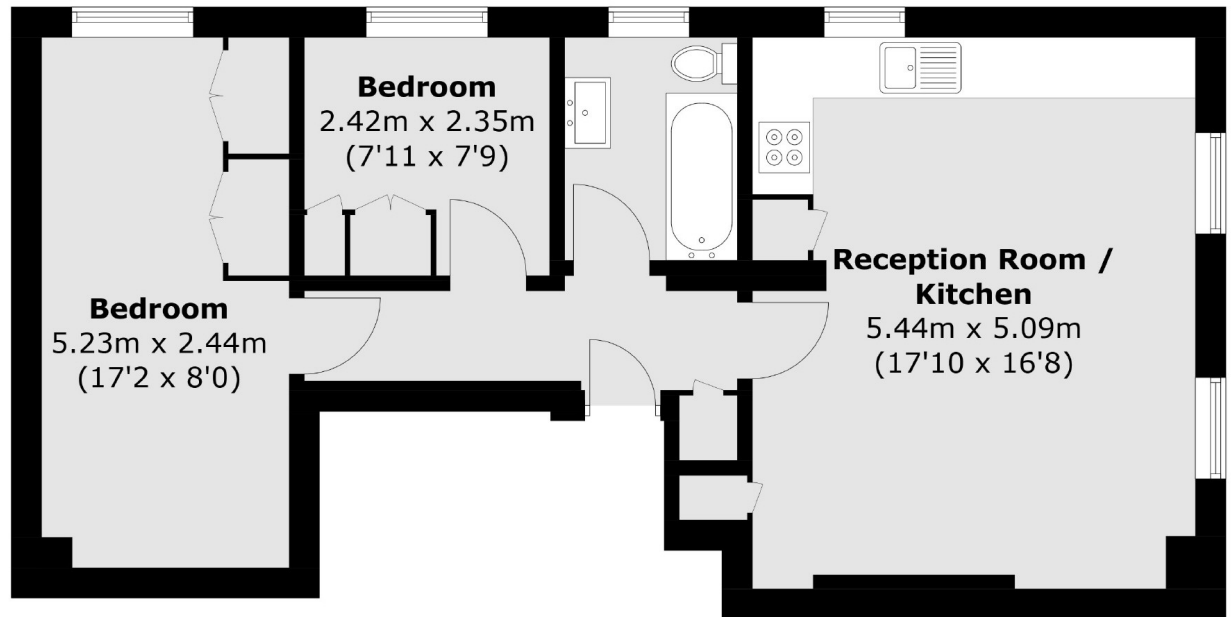

### First Floor

Total area (approx.): 53.2 sq. m (572.6 sq. ft)

### KEY FEATURES

- Share of Freehold
- Two Bedrooms
- Service Charge: c. £4162 pa
- No Onward Chain
- Tax Band: F
- Sole Agent

Energy Rating: C. We aim to make our particulars both accurate and reliable. However they are not guaranteed; nor do they form part of an offer or contract. If you require clarification on any points then please contact us, especially if you are travelling some distance to view. Please note that appliances and heating systems have not been tested and therefore no warranties can be given as to their good working order.

ASKING PRICE: £635,000

PIMLICO

020 7828 4050

pimlicosales@jackson-stops.com

jackson-stops.co.uk

JACKSON-STOPS 