



ST. GEORGES SQUARE
PIMLICO

JACKSON-STOPS 

ST. GEORGES SQUARE PIMLICO, SW1V

ASKING PRICE: £675 PER WEEK

A sizeable ground floor flat in leafy St. Georges Square.

The reception room has high ceilings and large windows overlooking the gardens, both bedrooms are double with good storage.

Just 0.2 miles from Pimlico Underground Station, 0.6 miles from Vauxhall Station, 0.9 miles from Victoria Station and 0.9 miles from Battersea Park.



KEY FEATURES

- Two bedrooms
- Bathroom
- Kitchen
- Reception
- Unfurnished
- Tax Band: F



St. Georges Square

Approximate Gross Internal Area = 833 sq ft / 77.4 sq m

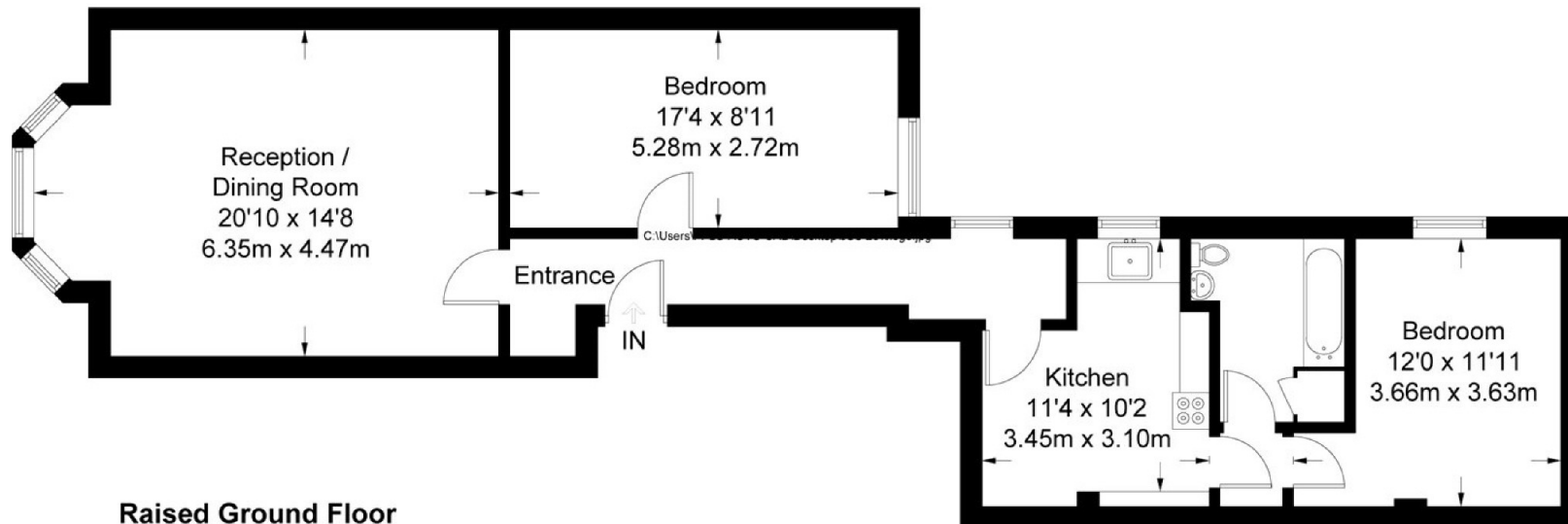

Raised Ground Floor

Not to scale, for guidance only and must not be relied upon as a statement of fact.
All measurements and areas are approximate only and have been prepared in
accordance with the current edition of the RICS Code of Measuring Practice.

Energy Rating: D. We aim to make our particulars both accurate and reliable. However they are not guaranteed; nor do they form part of an offer or contract. If you require clarification on any points then please contact us, especially if you are travelling some distance to view. Please note that appliances and heating systems have not been tested and therefore no warranties can be given as to their good working order.

ASKING PRICE: £675 PER WEEK

PIMLICO

020 7828 4243

pimlicolettings@jackson-stops.com

jackson-stops.co.uk

JACKSON-STOPS 