



WINCHESTER STREET
PIMLICO

JACKSON-STOPS 

WINCHESTER STREET PIMLICO, SW1V

ASKING PRICE: £1,300,000

A rare opportunity to acquire the ground, first and second floors of this period, part stucco fronted family home in Pimlico, SW1.

On the market for the first time in almost 20 years, this property has the added benefit of its own front door, providing added security and extra privacy, as well as a superb roof terrace and no onward chain. Subject to all necessary consents and permissions, there is also the possibility of constructing a mansard extension.

Winchester Street is convenient for local shopping as well as transport links. Victoria Mainline, Underground and Gatwick Express services are 0.3 miles away. Sloane Square, leading to fashionable shops, bars and restaurants, is 0.7 miles away. Battersea Park, to the south, with its wide open spaces is 0.7 miles away.

Tenure: Leasehold + Share of Freehold

KEY FEATURES

- Potential For Mansard (STP)
- Two Balconies
- Private Roof Terrace
- Private Front Door
- Tax Band: G





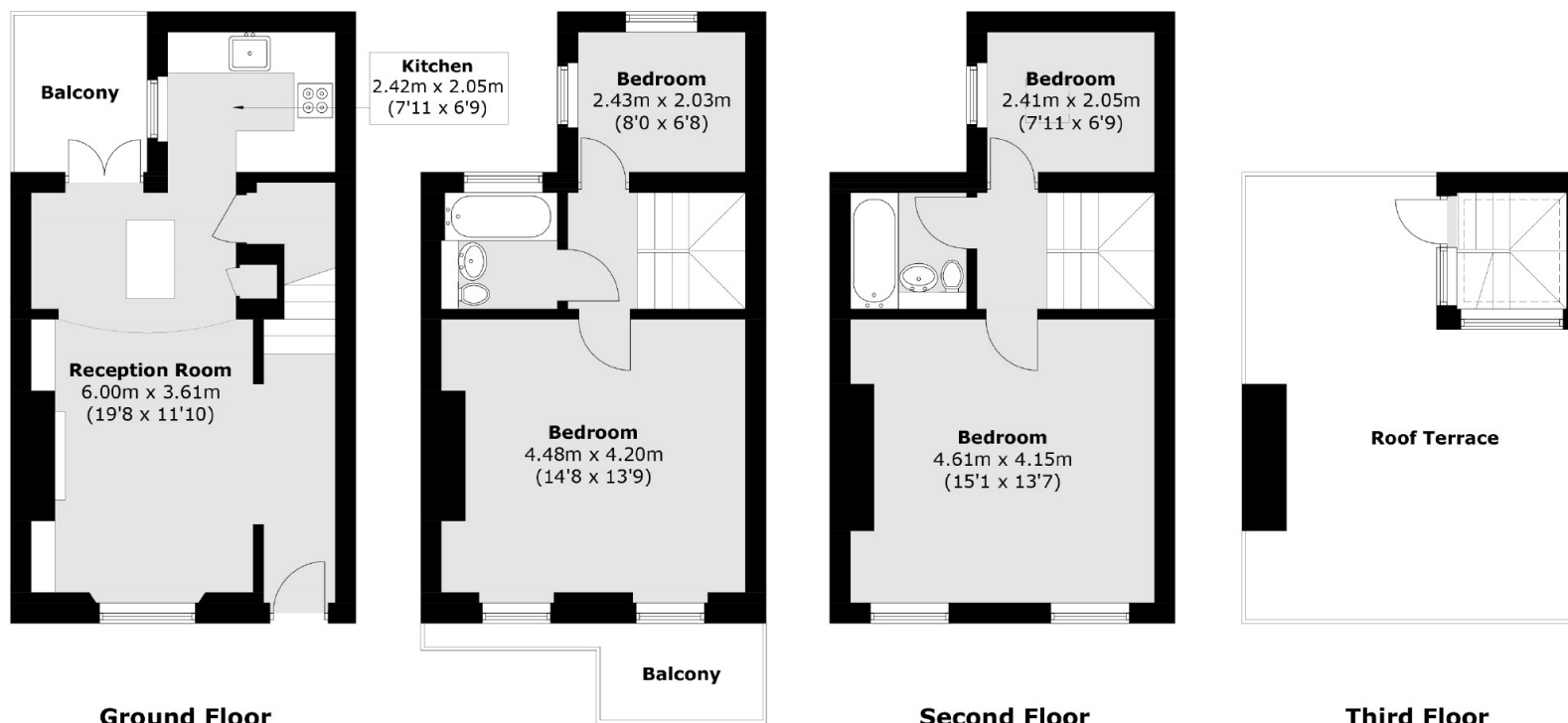

Total area (approx.): 99.8 sq. m (1,074.1 sq. ft)
 Roof Terrace / Balcony area (approx.): 30.5 sq. m (328.3 sq. ft)

Energy Rating: D. We aim to make our particulars both accurate and reliable. However they are not guaranteed; nor do they form part of an offer or contract. If you require clarification on any points then please contact us, especially if you are travelling some distance to view. Please note that appliances and heating systems have not been tested and therefore no warranties can be given as to their good working order.

ASKING PRICE: £1,300,000

PIMLICO

020 7828 4050

pimlicosales@jackson-stops.com

jackson-stops.co.uk

JACKSON-STOPS 