



GREYCOAT GARDENS
WESTMINSTER

JACKSON-STOPS 

GREYCOAT GARDENS, WESTMINSTER, SW1P

ASKING PRICE: £472,000

A superb opportunity to purchase a first floor apartment measuring circa 600sqft that is being offered to the market in Victoria, SW1.

Subject to planning to all the necessary permissions and consents the property could be reconfigured into a well-proportioned one-bedroom apartment.

Located in this handsome mansion block just off of Vincent Square, Westminster, SW1 it is offered for sale with no onward chain. This would suit all those looking for a centrally located apartment be they first time buyers, a pied-a-terre purchaser or buy to let investor; this having been an excellent buy to let for our client.

KEY FEATURES

- Mansion Block
- Full Time On-Site Concierge
- Bike Shed
- Communal Patio
- Tax Band: D
- No Onward Chain

Energy Rating: D. We aim to make our particulars both accurate and reliable. However they are not guaranteed; nor do they form part of an offer or contract. If you require clarification on any points then please contact us, especially if you are travelling some distance to view. Please note that appliances and heating systems have not been tested and therefore no warranties can be given as to their good working order.

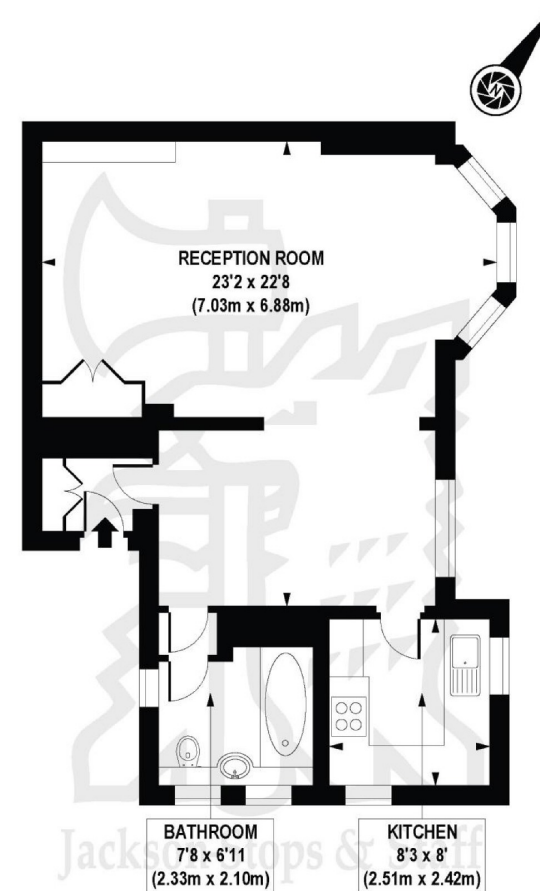

FIRST FLOOR

APPROX. GROSS INTERNAL FLOOR AREA 598 sq. ft / 55.53 sq. m

COMPLIANT WITH RICS CODE OF MEASURING PRACTICE Floorplan is for illustrative purposes only and is not to scale. Every attempt has been made to ensure the accuracy of the floorplan shown, however all measurements, fixtures, fittings and data shown are an approximate interpretation for illustrative purposes only. Liability for errors, omissions or mis-statement through negligence or otherwise is hereby excluded.



ASKING PRICE: £472,000

PIMLICO

020 7828 4050

pimlicosales@jackson-stops.com

jackson-stops.co.uk

JACKSON-STOPS 