



Adamsrill Road, SE26 | Guide Price £675,000

02087029777

sydenham@pedderproperty.com

pedder
We live local



In General

- Characterful and charming
- Two living areas
- Kitchen open into dining space
- Three bedrooms
- Beautifully fitted bathroom
- Utility room
- South facing garden
- Excellent transport links
- Very close to Mayow Park
- Front garden

In Detail

Guide price £675,000 - £700,000

A gorgeous three bed Victorian end of terrace located moments from the open green spaces of Mayow Park and local community garden, with excellent transport connections and a vibrant mix of amenities along the high street.

There’s something very charming about this house, a warmth and character that instantly makes it feel inviting. Blending period charm with a modern feel, the home is arranged over two floors, offering well-proportioned spaces filled with natural light.

At the front, a bright lounge creates a welcoming atmosphere, featuring a large bay window, honey stained wood flooring, and a classic wood burner as a focal point. The dining area seamlessly connects to the kitchen, forming an ideal setting for entertaining and family gatherings. The kitchen itself combines character with contemporary touches, offering ample storage and generous workspace.

Upstairs, there are three bedrooms, the third currently used as a study, and a beautifully fitted family bathroom. Additionally there access to the loft which has been boarded and insulated, with potential to extend STPP.

Adamsrill Road is a lovely community, ideally situated close to Mayow Park and the popular Brown + Green café. Nearby Bell Green offers a variety of shopping options, while excellent transport links, including Lower Sydenham (for Charing Cross) and Sydenham Overground/Underground, make commuting and exploring London easy.

EPC: D | Council Tax Band: D



Floorplan

Adamsrill Road SE26

Approximate Gross Internal Area
Ground Floor = 48.6 sq m / 523 sq ft
First Floor = 44.9 sq m / 483 sq ft
Total = 93.5 sq m / 1006 sq ft

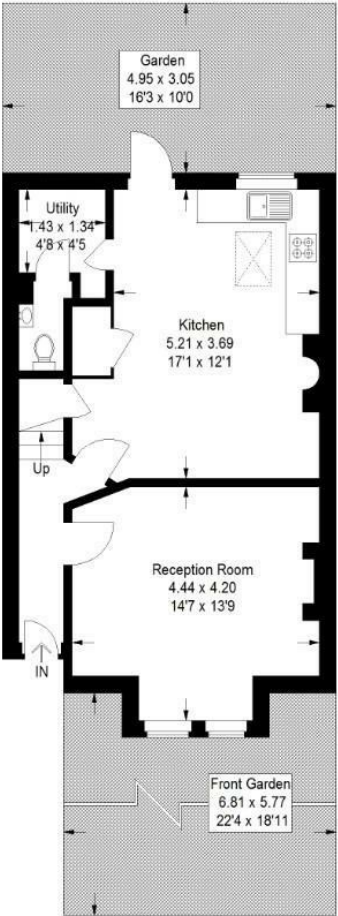

Ground Floor



First Floor

Copyright www.pedderproperty.com © 2021
These plans are for representation purposes only as defined by RICS - Code of Measuring Practice.
Not drawn to Scale. Windows and door openings are approximate. Please check all dimensions, shapes and compass bearings before making any decisions reliant upon them.

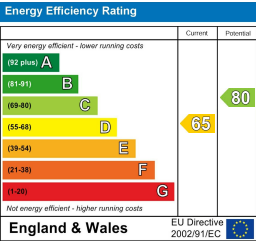

Pedder Property Ltd trading as Pedder for themselves and for the vendor/landlord of this property whose agents they are, give notice that (1) these particulars do not constitute any part of an offer or contract, (2) all statements contained within these particulars are made without responsibility on the part of Pedder or the vendor/landlord, (3) whilst made in good faith, none of the statements contained within these particulars are to be relied upon as a statement of representation or fact, (4) any intending purchaser/tenant must satisfy him/herself by inspection or otherwise as to the correctness of each of the statements contained within these particulars, (5) the vendor/landlord does not make or give either Pedder or any person in their employment any authority to make or give representation or warranty whatsoever in relation to this property.