

clever



16 Wellington Street

, Plymouth, PL4 8NB

Offers in excess of £160,000



Nestled in the heart of Plymouth on the desirable Wellington Street, this charming mid-terrace house presents an excellent opportunity for both first-time buyers and savvy investors. Spanning an impressive 1,733 square feet, the property boasts a rich history, having been built in 1880, and is brimming with potential for refurbishment to create a truly personalised home.

The residence features three well-proportioned bedrooms, including a convenient en-suite, ensuring ample space for family living or guest accommodation. A spacious reception rooms offer a welcoming atmosphere, perfect for entertaining or relaxing with loved ones. The fitted kitchen provides a functional space for culinary endeavours, ready to be transformed into your dream cooking area.

Situated in a sought-after central location, this property benefits from easy access to local amenities, transport links, and the vibrant culture that Plymouth has to offer. While the house is in need of refurbishment, it presents a blank canvas for those looking to inject their own style and flair.

This property is not just a house; it is a fantastic investment opportunity or a perfect first buy for those looking to establish themselves in a thriving community. With its blend of character, space, and potential, this home is sure to attract considerable interest. Do not miss the chance to make it your own.



Area Map



Floor Plans

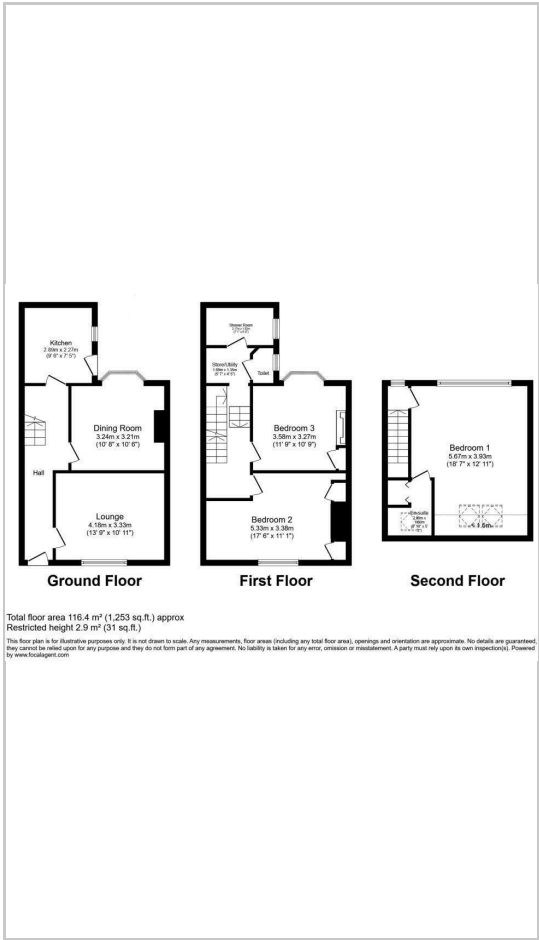

Energy Efficiency Graph

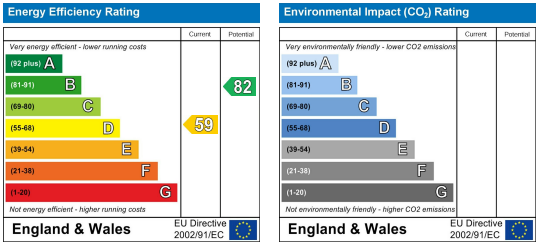

These particulars, whilst believed to be accurate are set out as a general outline only for guidance and do not constitute any part of an offer or contract. Intending purchasers should not rely on them as statements of representation of fact, but must satisfy themselves by inspection or otherwise as to their accuracy. No person in this firms employment has the authority to make or give any representation or warranty in respect of the property.