

clever



28 Mount Gould Road

, Plymouth, PL4 7PT

Asking price £395,000



RECENTLY REFURBISHED PERIOD PROPERTY BENEFITTING FROM EIGHT EN-SUITE ROOMS, LARGE, ENCLOSED GARDEN, AMPLE OFF-STREET PARKING AND ROOF TERRACE WITH STUNNING VIEWS - EXCELLENT INVESTMENT OPPORTUNITY WITH POTENTIAL RENTS EXCEEDING £52,000 EPC D.

Fantastic spacious property located in Mount Gould. The accommodation comprises of eight double bedrooms seven having newly installed en-suite Shower Rooms an additional Shower Room and separate w.c, spacious communal lounge area, utility room and fitted kitchen. The outside offers a large, enclosed rear lawned garden with off road parking, this property also has the added benefits of a roof terrace offering lovely views. Benefits include gas central heating and double glazing. No onward chain. An early viewing is highly recommended.

Located Centrally, this property is close to the City Centre, Plymouth University, Freedom Fields Park and many other of Plymouth's beauty spots. Close to a wide variety of local amenities including Mutley Plain which offers shops, coffee shops and much more. Good transport links located close by.

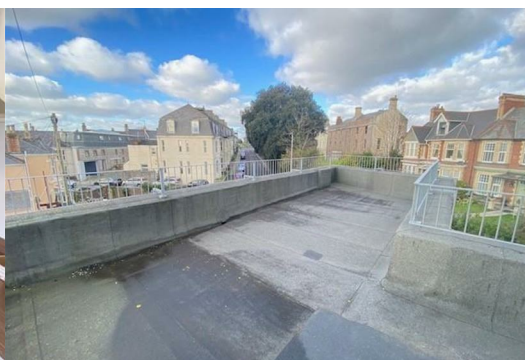

Area Map



Floor Plans

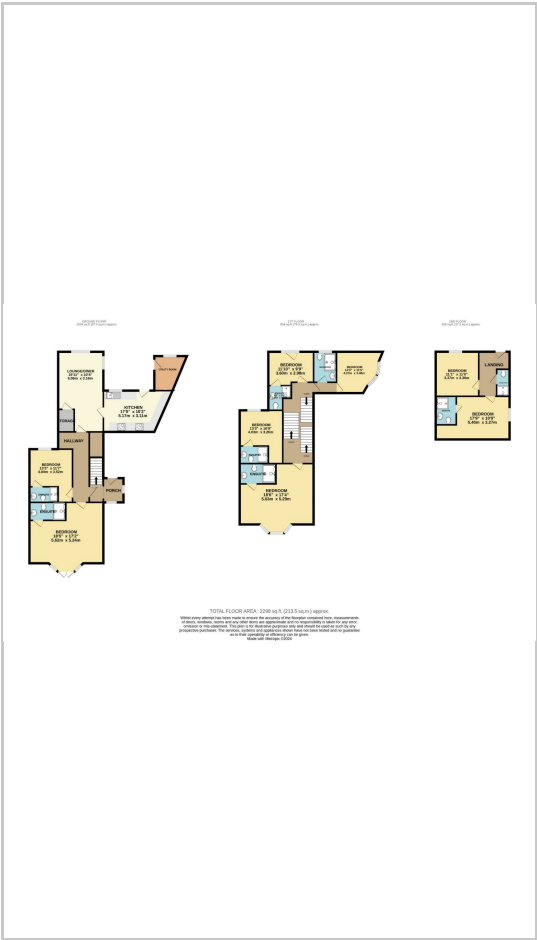

Energy Efficiency Graph



These particulars, whilst believed to be accurate are set out as a general outline only for guidance and do not constitute any part of an offer or contract. Intending purchasers should not rely on them as statements of representation of fact, but must satisfy themselves by inspection or otherwise as to their accuracy. No person in this firm's employment has the authority to make or give any representation or warranty in respect of the property.