

clever



42 Furzehill Road

, Plymouth, PL4 7JZ

Guide price £260,000



GUIDE £260,000 TO £270,000

FANTASTIC INVESTMENT OPPORTUNITY - STUDENT ADVERTISED FOR LET FOR 2024/25 PRODUCING GROSS INCOME OF £33,000 PA.

Situated in a desirable central location, being within walking distance of Plymouth University, Mutley Plain and Plymouth City Centre making this a sound investment for years to come. The accommodation spans two storeys comprising six en-suite Letting Rooms, Communal Living Room, well-appointed fitted Kitchen and useful Utility. Additional benefits include central heating and double glazing.



Area Map



Floor Plans

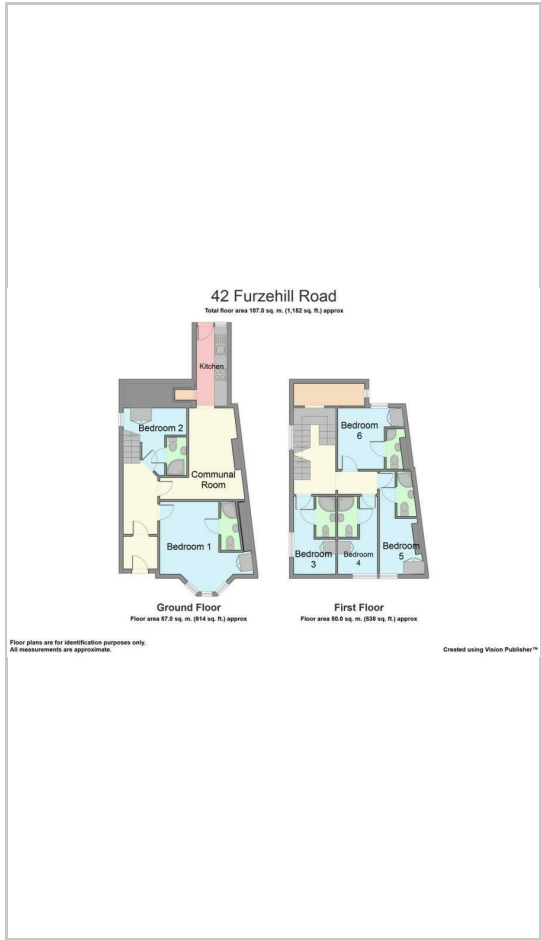

Energy Efficiency Graph

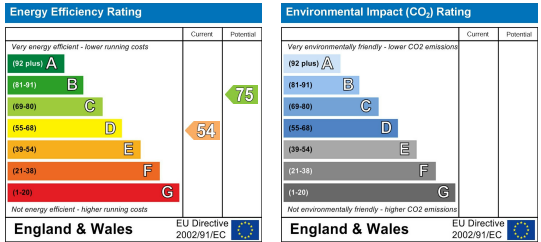

These particulars, whilst believed to be accurate are set out as a general outline only for guidance and do not constitute any part of an offer or contract. Intending purchasers should not rely on them as statements of representation of fact, but must satisfy themselves by inspection or otherwise as to their accuracy. No person in this firm's employment has the authority to make or give any representation or warranty in respect of the property.