



**ROBINSONS**

## Farm Close

Bedford, MK45 2UF

**£325,000**

- SITUATED IN DESIRABLE MARKET TOWN OF AMPHILL
- DRIVEWAY PARKING FOR TWO CARS
- SUNNY WESTERLY FACING REAR GARDEN
- RENTAL OPPORTUNITY £1400pcm
- HIGH SPECIFICATION KITCHEN WITH FULLY INTEGRATED APPLIANCES
- BACKING ONTO ALLOTMENTS
- IDEAL FIRST TIME BUY
- ACCESS TO HIGHLY-RATED SCHOOL CATCHMENTS
- BUILT IN WARDROBES IN BOTH BEDROOMS
- EXCELLENT LINKS TO MAINLINE STATION TO ST PANCARAS



Floor Plan

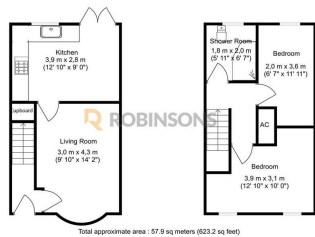

Robinsons produced by Microsoft Photoscape  
Floorplan is for illustration purposes only and all measurements are approximate

Area Map

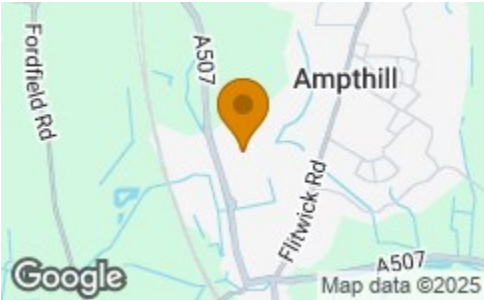

Energy Efficiency Graph

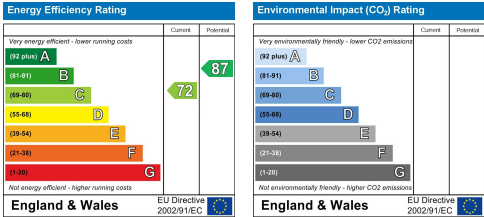

These particulars, whilst believed to be accurate are set out as a general outline only for guidance and do not constitute any part of an offer or contract. Intending purchasers should not rely on them as statements of representation of fact, but must satisfy themselves by inspection or otherwise as to their accuracy. No person in this firms employment has the authority to make or give any representation or warranty in respect of the property.

20 West Street, Dunstable,  
Bedfordshire, LU6 1SX

20 West Street, Dunstable,  
Bedfordshire, LU6 1SX

robinsons-estates.co.uk  
sales@robinsons-estates.co.uk