



Dale Close

Dunstable, LU5 4QD

£300,000

- NO UPPER CHAIN
- TWO BEDROOMS
- RENOVATED TO A HIGH SPECIFICATION
- IDEAL FIRST TIME BUY OR BUY TO LET
- BOILER FITTED JANUARY 2024
- SOUGHT AFTER EAST DUNSTABLE
- LOW MAINTENANCE REAR GARDEN
- BRAND NEW CARPETS & FLOORING THROUGHOUT
- OFF ROAD PARKING FOR TWO CARS
- RENTAL POTENTIAL £1,350PCM



Floor Plan

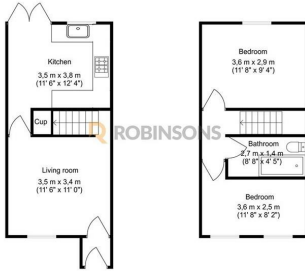

Total approximate area : 56.3 meters (606.0 sq feet)

Images produced by Microsoft Photogrammetry
Floorplan is for illustrative purposes only and all measurements are approximate

Area Map



Energy Efficiency Graph

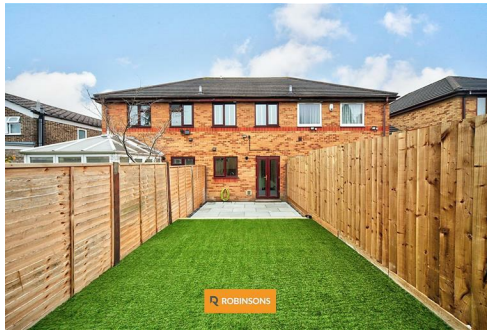
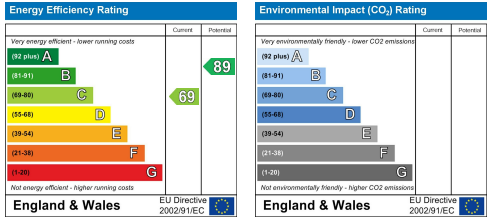

These particulars, whilst believed to be accurate are set out as a general outline only for guidance and do not constitute any part of an offer or contract. Intending purchasers should not rely on them as statements of representation of fact, but must satisfy themselves by inspection or otherwise as to their accuracy. No person in this firm's employment has the authority to make or give any representation or warranty in respect of the property.