



Arkley Road

Hemel Hempstead, HP2 7JT

Offers Over £200,000

- NO UPPER CHAIN
- EXTENDED LEASE
- SHORT DISTANCE TO M1 & M25
- RESIDENT PARKING
- SERVICE CHARGE £102PM
- TWO BEDROOM GROUND FLOOR
- WOODHALL FARM
- GROUND FLOOR APARTMENT
- PRIVATE BLOCK IN CUL DE SAC
- GROUND RENT £150 PER YEAR



Floor Plan

Ground Floor

Approx. 46.8 sq. metres (503.9 sq. feet)

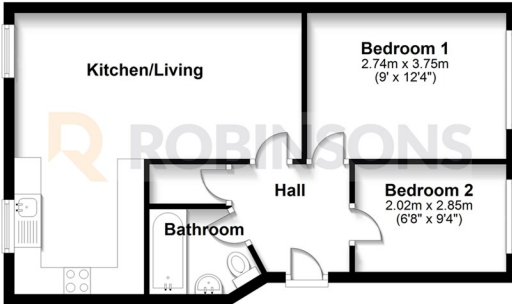

Total area: approx. 46.8 sq. metres (503.9 sq. feet)

Area Map



Energy Efficiency Graph

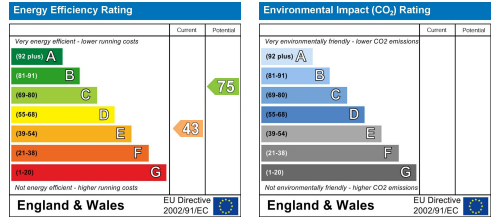

These particulars, whilst believed to be accurate are set out as a general outline only for guidance and do not constitute any part of an offer or contract. Intending purchasers should not rely on them as statements of representation of fact, but must satisfy themselves by inspection or otherwise as to their accuracy. No person in this firm's employment has the authority to make or give any representation or warranty in respect of the property.

20 West Street, Dunstable,
Bedfordshire, LU6 1SX

20 West Street, Dunstable,
Bedfordshire, LU6 1SX

robinsons-estates.co.uk
sales@robinsons-estates.co.uk