

**Pinewood Gardens  
Teddington  
TW11 9FH**

£3,245 PCM

**ChaseBuchanan**



# Apartment 64



APARTMENT LOCATOR

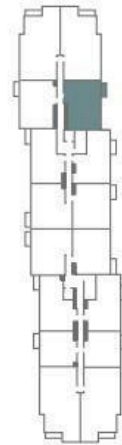

RIVER THAMES

FLOOR 5
FLOOR 4
<b>FLOOR 3</b>
FLOOR 2
FLOOR 1
GROUND FLOOR

TOTAL APARTMENT AREA	79 SQ M	850 SQ FT	TOTAL BALCONY AREA	4 SQ M	43 SQ FT
LIVING / KITCHEN / DINING	4.06 M X 7.66 M	13'4" X 25'1"	EN-SUITE	2.30 M X 3.10 M	7'7" X 10'2"
MASTER BEDROOM	3.63 M X 3.53 M	11'11" X 11'7"	SHOWER	2.44 M X 1.67 M	8'0" X 5'6"
BEDROOM 2	2.78 M X 3.36 M	9'1" X 11'0"	BALCONY	3.16 M X 1.50 M	10'4" X 4'11"

Energy Efficiency Rating	Current	Target	Environmental Impact (CO <sub>2</sub> ) Rating	Current	Target
Very energy efficient - lower running costs			Very environmentally friendly - lower CO <sub>2</sub> emissions		
A			A		
B			B		
C			C		
D			D		
E			E		
F			F		
G			G		

- Prestigious riverside development
- High spec throughout
- Two bathrooms
- Allocated underground parking
- Private balcony
- Two bedroom
- Stunning grounds
- Council tax band - F

Nestled in a brand new prestigious development on the banks of the River Thames is this stunning two bedroom and two bathroom apartment.

This two bedroom apartment is of generous size and finished to the highest of standards. With a large kitchen and living area, which has doors leading to a private balcony. There are two double bedrooms, ample storage, a modern en suite bathroom with a separate shower to the master and a further luxury shower room.

This Riverside location is in a sought after location with easy access to all the delights of Teddington high street, the station is only a short walk away and the Lensbury gym and spa is almost next door. As a resident you will benefit from a 24 hour concierge and secure allocated underground parking.

Chase Buchanan are bonded members of ARLA PropertyMark.

For more information or to book a viewing, please contact:

020 8977 1066

**ChaseBuchanan**

43 High Street, Teddington, TW11 8HB