

**Pinewood Gardens  
Teddington  
TW11 9FH**

£4,910 PCM

**ChaseBuchanan**





# Apartment 47



APARTMENT LOCATOR

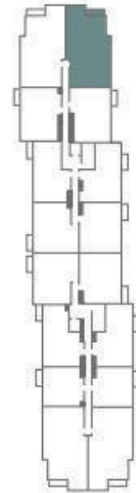

RIVER THAMES

FLOOR 5
FLOOR 4
FLOOR 3
<b>FLOOR 2</b>
FLOOR 1
GROUND FLOOR

TOTAL APARTMENT AREA	116 SQ M	1249 SQ FT	TOTAL BALCONY AREA	5 SQ M	54 SQ FT
----------------------	----------	------------	--------------------	--------	----------

Energy Efficiency Rating	Current	Target
Very energy efficient - lower running costs		
A		
B		
C		
D		
E		
F		
G		

Environmental Impact (CO <sub>2</sub> ) Rating	Current	Target
Very environmentally friendly - lower CO <sub>2</sub> emissions		
A		
B		
C		
D		
E		
F		
G		

- Prestigious development
- Impressive open plan living
- Two bathrooms plus WC
- Idyllic riverside location
- A selection of three bedroom apartments
- Most with private balcony

Located in an idyllic riverside location, is this impressive three bedroom apartment finished to the highest of standards. Designed by award-winning architects Hamiltons on the original site of Teddington Studios.

This stunning third floor apartment offers light and spacious accommodation, all immaculately presented. The open plan living room incorporates a sophisticated, ultra-modern kitchen with island and doors to a private terrace providing great views over Teddington. With three bedrooms, the master having an en-suite bathroom with separate shower plus his and her sinks, a further shower room and separate WC. Storage is ample here.

Located in an enviable location on the banks of the River Thames with the amenities of Teddington high street and station close by with good transport links to London, Waterloo. Residents within this prestigious development also benefit from underground allocated parking and access to a 24 hour concierge service.

Chase Buchanan are bonded members of ARLA PropertyMark.

For more information or to book a viewing, please contact:

020 8977 1066

**ChaseBuchanan**

43 High Street, Teddington, TW11 8HB