

**Elton Close
Hampton Wick
KT1 4EE**

£335,000

ChaseBuchanan



Elton Close KT1

Approx. Gross Internal Floor Area
44.3 Sq M - 477 Sq Ft

Chase Buchanan

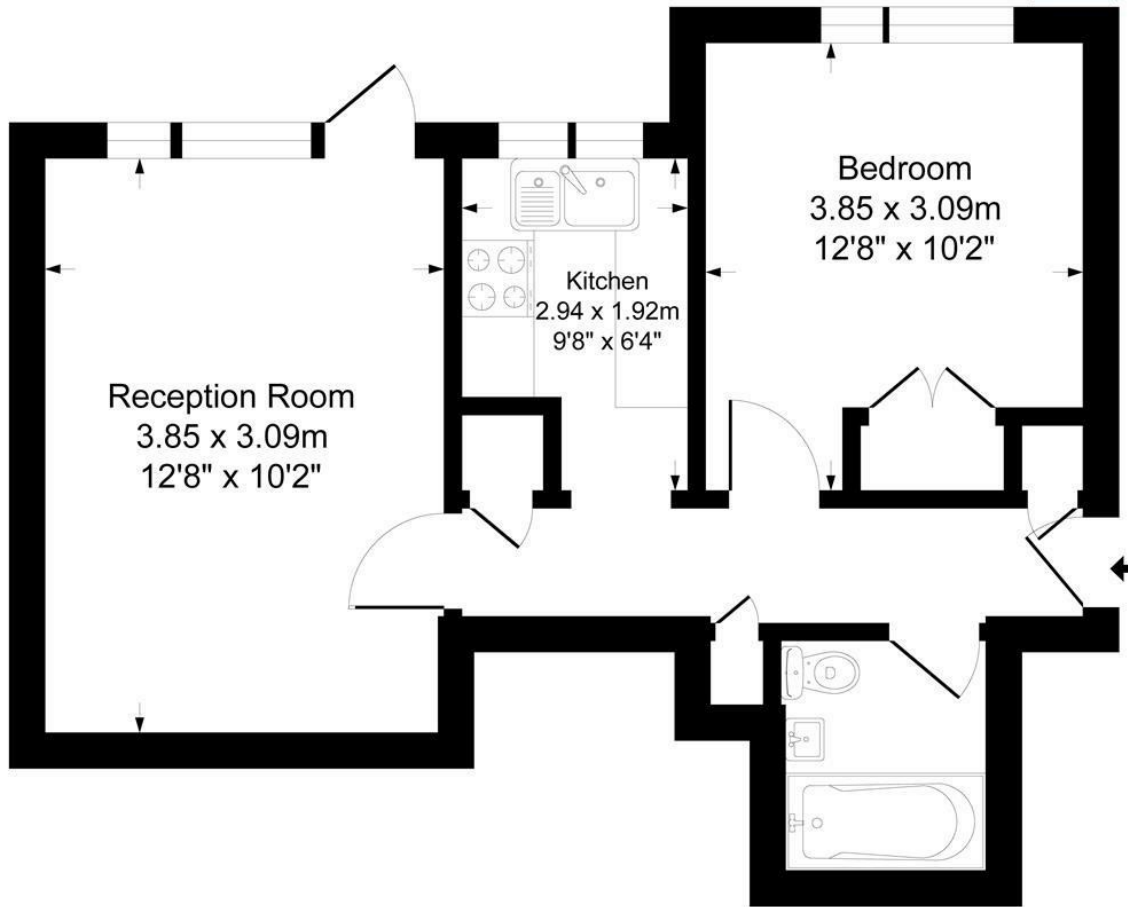
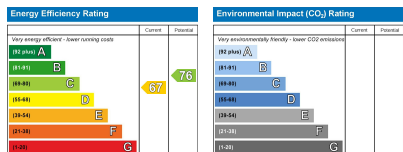

Illustration for identification purposes only, measurements are approximate, not to scale.
Produced By Esjay Property Marketing



- Viewings accompanied by Chase Buchanan
- Access to communal gardens
- Separate, modern kitchen
- Ground floor
- Double bedroom
- Close to train station and Kingston town centre

A charming one double bedroom purpose-built ground floor apartment situated in a popular block and offered to the market with no onward chain. Ideal for first time buyers and investment purchasers this property is also comes with allocated parking and a long lease.

Inside there is a lounge which has direct access onto the gardens, modern kitchen and bathroom, double bedroom, and security entry phone system.

Close by there are many boutique shops, restaurants, and the amenities of Teddington, Kingston and Twickenham, including the David Lloyd Leisure Centre and The prestigious Lensbury Club. Locally there are excellent transport links, with Hampton Wick train station offering direct access to London Waterloo and regular buses into Kingston and Richmond town centres.

If you are looking for an investment property, the rental figure would be approx. £1,400 pcm.

For more information or to book a viewing, please contact:

020 8977 1166

Chase Buchanan

43 High Street, Teddington, TW11 8HB