

Whist every attempt has been made to ensure the accuracy of the floor plan contained here, measurements of doors, windows, rooms and any other items are approximate and no responsibility is taken for any error, omission, or mis-statement. This plan is for illustrative purposes only and should be used as such by any prospective purchaser. The services, systems and appliances shown have not been tested and no guarantee as to their operability or efficiency can be given
Made with Metropix ©2018

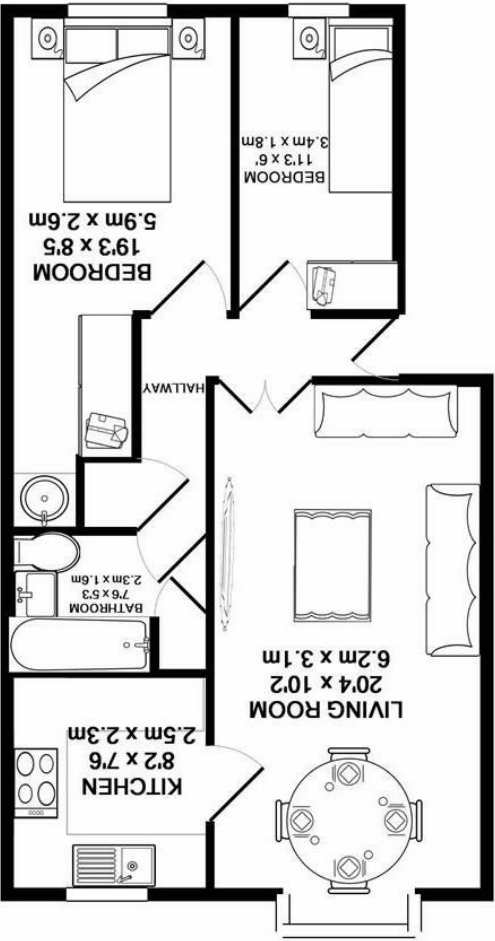



Flat 6 13 Poppy Close

Hackbridge, SM6 7HD

£1,500

- Available November 2025
- Lovely spacious two bedroom first floor flat
- Walking distance to Hackbridge BR station
- Allocated Parking Space
- Non Smokers, No Pets
- EPC Band C
- Viewing Highly Recommended

Available November 2025 - Silverman Black is delighted to offer this spacious and well presented two bedroom top floor apartment located on a select modern development with a few minutes walk of Hackbridge BR station. The flat comprises of a spacious Living area with well equipped kitchen, a double bedroom with a walk-in wardrobe & sink unit, a single bedroom and a very nicely refitted bathroom. Other benefits include use of a good size loft for storage, night storage heating, resident's parking facilities. No pets, non smokers. Viewing is highly recommended - so call today to book an appointment.

