



**Coopers**

**Coopers**

Lowry Mews, Cheylesmore, Coventry CV3 5QD

Leasehold: £140,000





## Lowry Mews, 151 Dillotford Avenue

Cheylesmore, Coventry

Bright top floor living with big roof lights, a smart open plan layout, granite kitchen and a clean modern finish. No chain. 108 years unexpired, service charge £128pm, ground rent £400pa. Council Tax band: B

Tenure: Leasehold

EPC Energy Efficiency Rating: C

- Modern top floor apartment with roof lights throughout
- Allocated parking spot in the gated, secure car park
- Open plan kitchen, dining and lounge
- Granite worktops and space for appliances
- Two well proportioned bedrooms
- Large bathroom with a clean modern finish
- Light and airy feel across the whole home
- Sold with no chain







## Second Floor

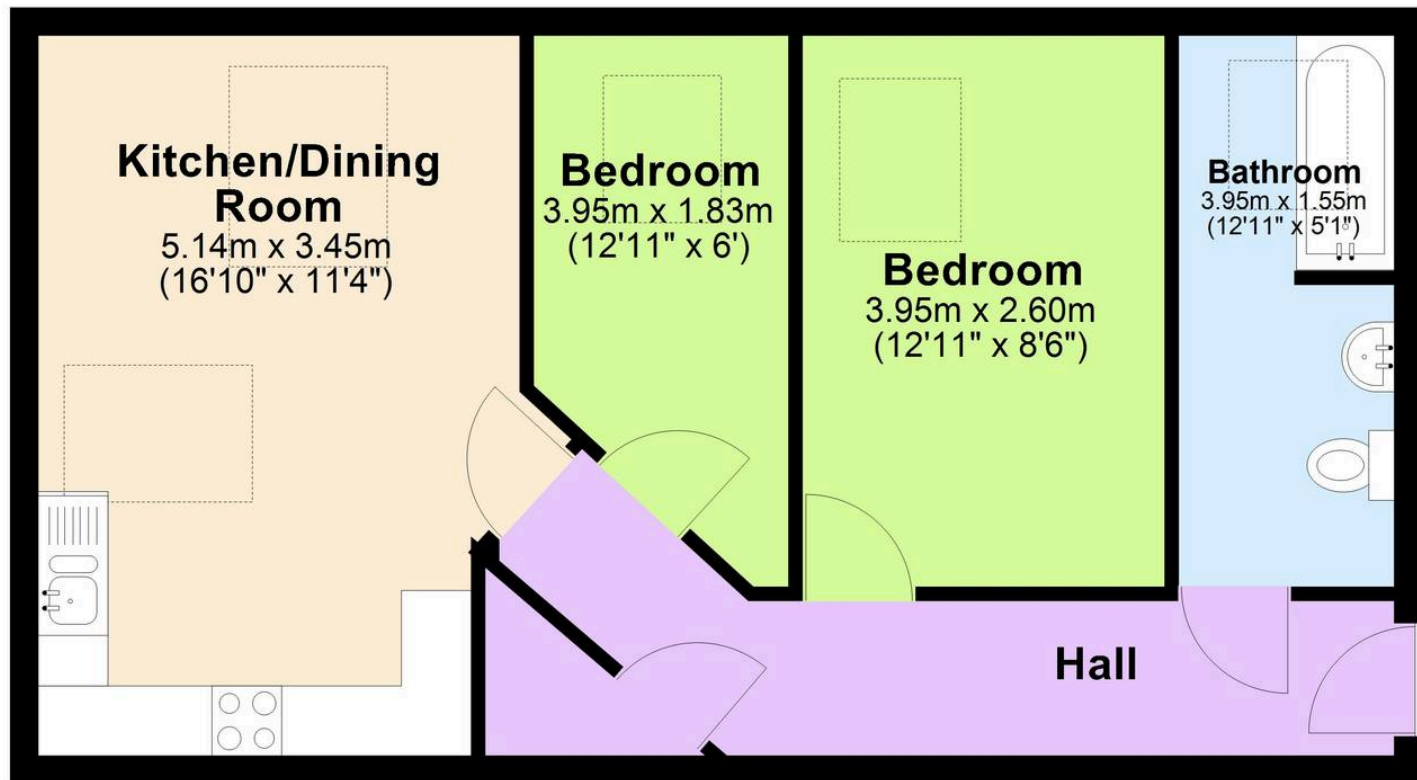

Total area: approx. 50.1 sq. metres (539.6 sq. feet)

"Floor plan measurements are approximate and are for illustrative purposes only. While every effort is made to ensure accuracy, no responsibility is taken for any error, omission, or misstatement. Do not scale from this plan.

Plan produced using PlanUp. □ □

**Coopers Estate Agents**

Coopers, 22 New Union Street – CV1 2HN

024 7655 2841 • [sales@coopersestateagents.com](mailto:sales@coopersestateagents.com) • [www.coopersestateagents.com/](http://www.coopersestateagents.com/)

**Coopers**

Coopers Chartered Surveyors Ltd, 22 New Union Street, Coventry, West Midlands

CV1 2HN, 024 7655 2841, [sales@coopers-cov.com](mailto:sales@coopers-cov.com). Company Registration

Number: 6725089 / VAT number: 940 3555 34