



Coopers

Coopers

Carlton Gardens, Warwick Ave, Earlsdon, Coventry CV5 6DJ

Guide Price £350,000



Carlton Gardens

Warwick Avenue, Coventry

One of the best apartments in Coventry! This superb ground floor self contained apartment enjoys panoramic views of Carlton Gardens. Offering spacious, well planned accommodation and must be viewed.

Council Tax band: D

Tenure: Leasehold

EPC Energy Efficiency Rating: C

EPC Environmental Impact Rating: C

- One of the best apartments in Coventry in a desired residential area!
- Well proportioned and spacious design
- Large living rooms with panoramic views of the gardens
- Larger than average breakfast kitchen
- Huge master bedroom with ensuite bathroom
- Further bedroom and shower room
- Must be viewed!



Entrance hallway

Living Room

Spacious and enjoying delightful views of the gardens.

Breakfast Kitchen

having a range of matching units with built in double oven and hob. Worcester gas fired boiler.

Huge Master Bedroom

with views down the gardens and range of built in wardrobes.

Spacious Ensuite Bathroom

Bedroom 2

A double room with a range of built in wardrobes.

Spacious Shower Room

with corner shower cubicle, washbasin and WC.

Outside

Most beautiful gardens.



Ground Floor

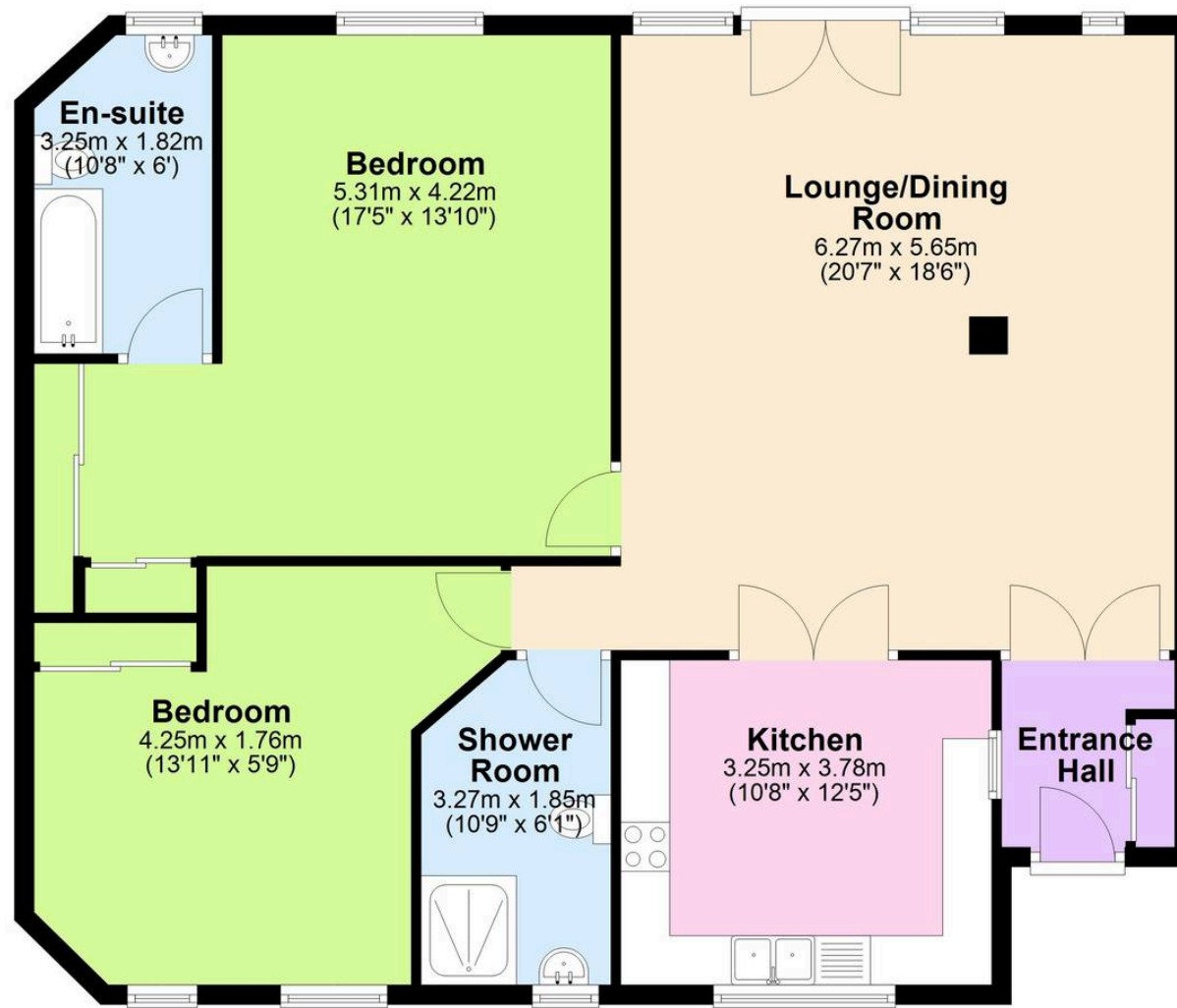

Total area: approx. 109.0 sq. metres (1173.7 sq. feet)

Coopers Estate Agents

Coopers, 22 New Union Street – CV1 2HN

024 7655 2841 • sales@coopersestateagents.com • www.coopersestateagents.com/

Coopers

Coopers Chartered Surveyors Ltd, 22 New Union Street, Coventry, West Midlands

CV1 2HN, 024 7655 2841, sales@coopers-cov.com. Company Registration

Number: 6725089 / VAT number: 940 3555 34