



**Coopers**

**Coopers**

Ashington Grove, Whitley, Coventry CV3 4DF

Freehold Price: £285,000



## Ashington Grove

Whitley, Coventry

OPEN DAY ON FRIDAY 15TH NOVEMBER. WE HAVE LIMITED AVAILABILITY SO CALL TO BOOK YOUR INDIVIDUAL SLOT. Fully refurbished 3-bed end-terrace home with open-plan layout, high-spec kitchen, utility/WC downstairs. 3 bedrooms, great bathroom. Front hardstanding, rear lawn, garage. Chain-free, move-in ready.

Council Tax band: B

Tenure: Freehold

EPC Energy Efficiency Rating: D

EPC Environmental Impact Rating: D

- OPEN DAY FRIDAY 15TH NOVEMBER – LIMITED AVAILABILITY. CALL TO BOOK YOUR SLOT
- Completely refurbished throughout
- Extended, open-plan layout downstairs
- Through lounge and dining room, leading directly into the kitchen area
- Separate utility, downstairs WC and understairs storage
- Three first floor bedrooms
- First floor bathroom
- Private garden with lawn area leading to a rear garage
- Block paved hardstanding to front garden





## Ground Floor

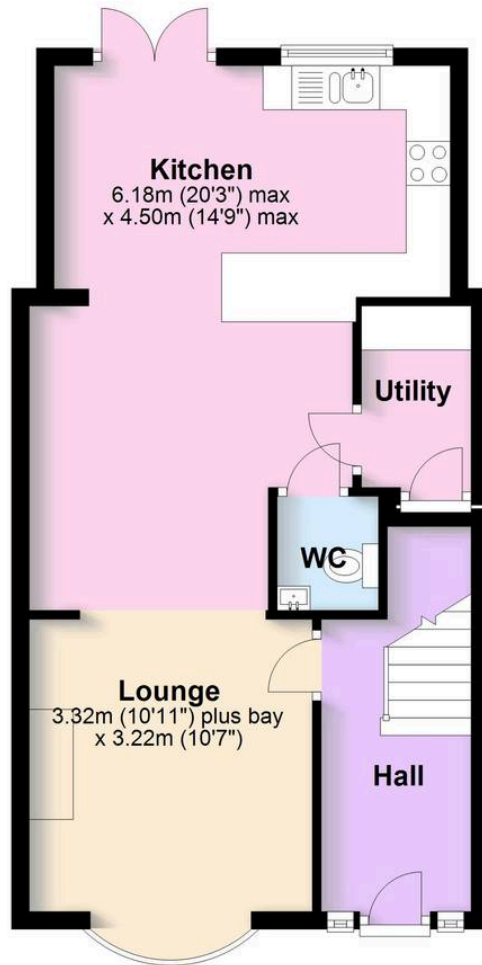

## First Floor

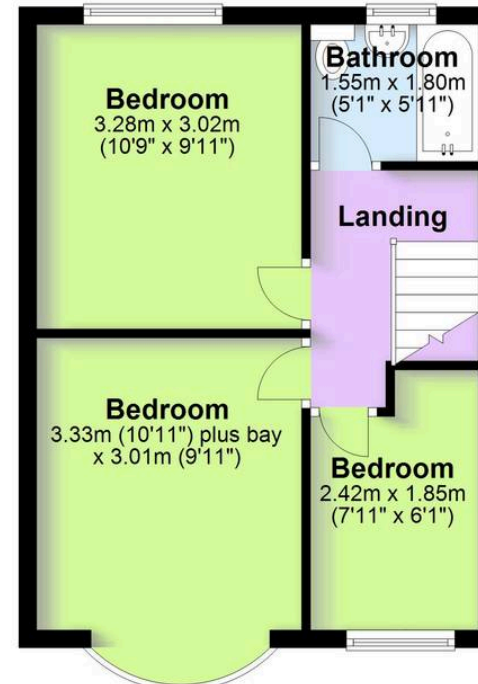

Total area: approx. 80.1 sq. metres (861.7 sq. feet)

This floor plan is for illustrative purposes only and should be used as such by any prospective purchaser. Whilst every attempt has been made to ensure the accuracy of this plan, measurements of doors, windows, rooms and other items are approximate and no responsibility is taken for any error, omission or mis-statement.  
Plan produced using PlanUp.

Coopers Estate Agents

Coopers, 22 New Union Street - CV1 2HN

**Coopers**

024 7655 2841 • sales@coopersestateagents.com • www.coopersestateagents.com/

Coopers Chartered Surveyors Ltd, 22 New Union Street, Coventry, West Midlands

CV1 2HN, 024 7655 2841, sales@coopers-cov.com. Company Registration

Number: 6725089 / VAT number: 940 3555 34