



Coopers

Coopers

Hiron Croft, Cheylesmore, Coventry CV3 6HU

Guide Price £325,000



Hiron Croft

Cheylesmore, Coventry

Three bedroom semi detached home realistically priced for early sale. Walking distance of the Memorial Park, Coventry Station, City Centre, excellent local schools and range of amenities. Private gardens, driveway and garage. Some upgrading to personal taste needed but really must be viewed.

Council Tax band: D

Tenure: Freehold

EPC Energy Efficiency Rating: D

EPC Environmental Impact Rating: D

- Semi detached family home in excellent location
- Lounge/Dining room and extended breakfast kitchen
- Three bedrooms and shower room
- Private gardens, driveway and garage
- Gas CH and double glazing
- Realistically priced, must be viewed





Ground Floor

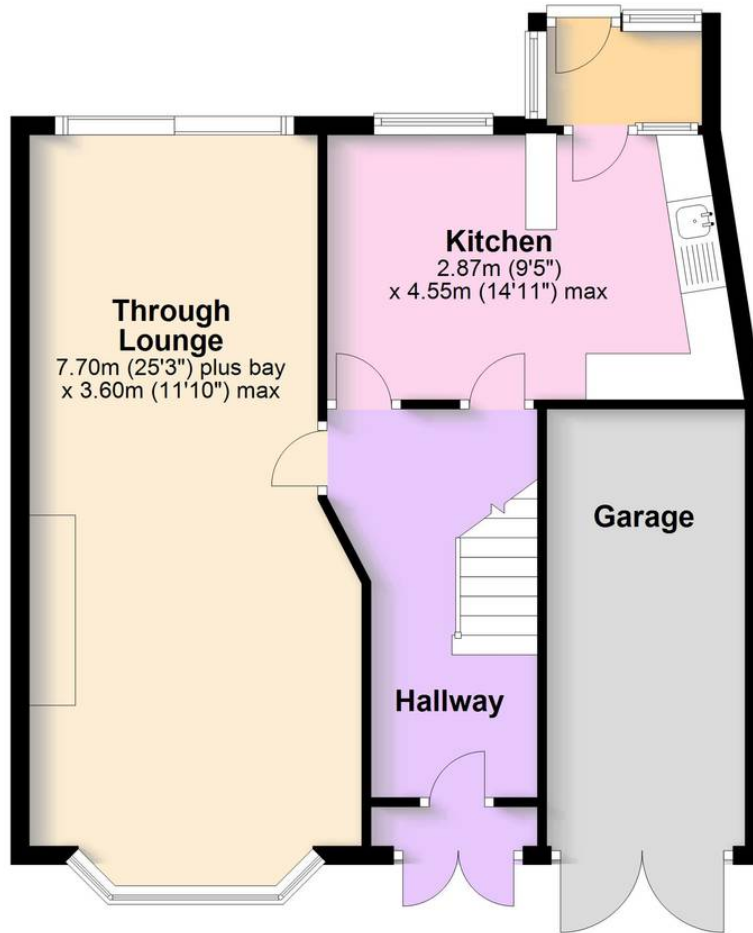

First Floor

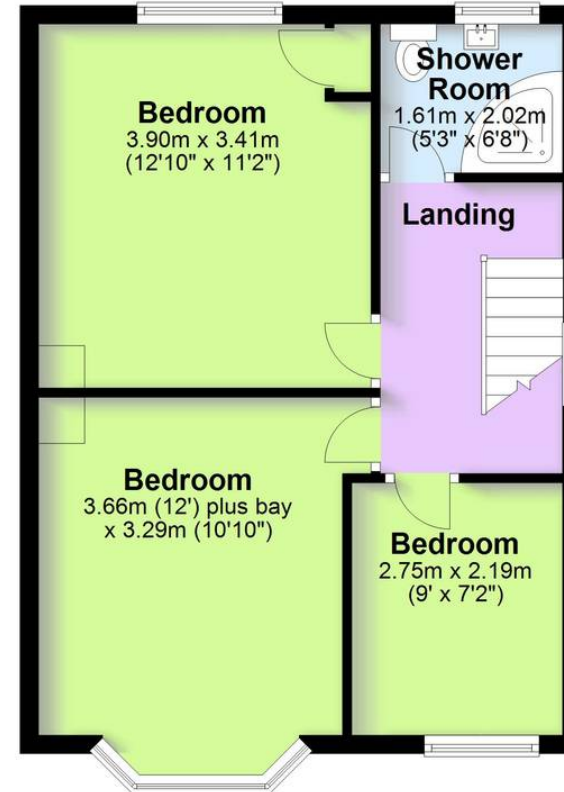

This floor plan is for illustrative purposes only and should be used as such by any prospective purchaser. Whilst every attempt has been made to ensure the accuracy of this plan, measurements of doors, windows, rooms and other items are approximate and no responsibility is taken for any error, omission or mis-statement.
Plan produced using PlanUp.

Coopers Estate Agents

Coopers, 22 New Union Street - CV1 2HN

Coopers

024 7655 2841 • sales@coopersestateagents.com • www.coopersestateagents.com/

Coopers Chartered Surveyors Ltd, 22 New Union Street, Coventry, West Midlands

CV1 2HN, 024 7655 2841, sales@coopers-cov.com. Company Registration

Number: 6725089 / VAT number: 940 3555 34