

Coopers



Coopers

Coopers

Hyde Road, Wyken, Coventry CV2 5ES

Guide Price £180,000



Hyde Road

Wyken, Coventry

Traditional style mid terraced three bedroom family home in ever popular position near Ansty Road on the east side of Coventry. Very competitively priced for early sale. Through hall, two separate living rooms and kitchen. Reasonable size gardens to front and rear.

Council Tax band: B

Tenure: Freehold

EPC Energy Efficiency Rating: D

- Traditional style family home
- Popular location on the east side of the City
- Two living rooms and kitchen
- Three bedrooms and shower room
- Front and rear gardens
- Competitively price for early sale





Ground Floor

Approx. 32.8 sq. metres (353.3 sq. feet)

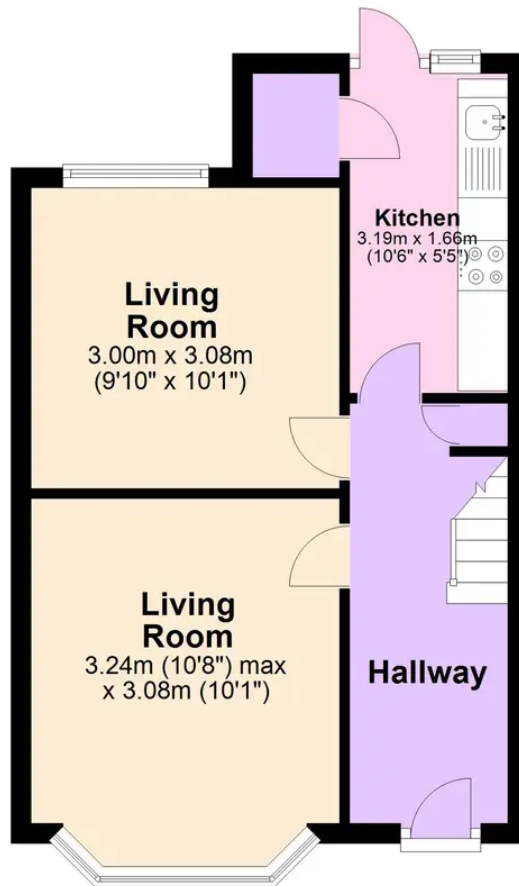

First Floor

Approx. 32.2 sq. metres (347.0 sq. feet)

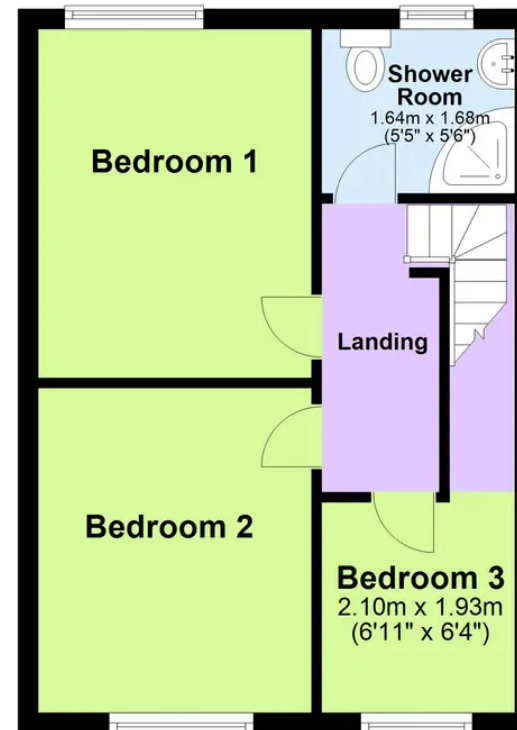

Total area: approx. 65.1 sq. metres (700.3 sq. feet)

This floor plan is for illustrative purposes only and should be used as such by any prospective purchaser. Whilst every attempt has been made to ensure the accuracy of this plan, measurements of doors, windows, rooms and other items are approximate and no responsibility is taken for any error, omission or mis-statement.

Plan produced using PlanUp.

Coopers Estate Agents

Coopers, 22 New Union Street - CV1 2HN

Coopers

Coopers Chartered Surveyors Ltd, 22 New Union Street, Coventry, West Midlands

CV1 2HN, 024 7655 2841, sales@coopers-cov.com. Company Registration

Number: 6725089 / VAT number: 940 3555 34

024 7655 2841 • sales@coopersstateagents.com • www.coopersstateagents.com/