



Cecily Road, Cheylesmore, Coventry CV3 5LB

Guide Price £315,000



Cecily Road

Cheylesmore, Coventry

Extended and with huge potential. Located near shops, city centre & train station. Extended kitchen & dining area, loft converted to 4th bed/home office. Pleasant garden & brick garage. Great family home with potential. Council Tax band: C

Tenure: Freehold

EPC Energy Efficiency Rating: E

EPC Environmental Impact Rating: E

- Four bedroom family home
- Popular location, close to Cheylesmore shops, the city centre and train station
- Extended kitchen and dining area
- Lofty conversion to create fourth bedroom
- Pleasant garden with brick garage
- Three first floor bedrooms and bathroom





Ground Floor

Approx. 49.6 sq. metres (533.7 sq. feet)

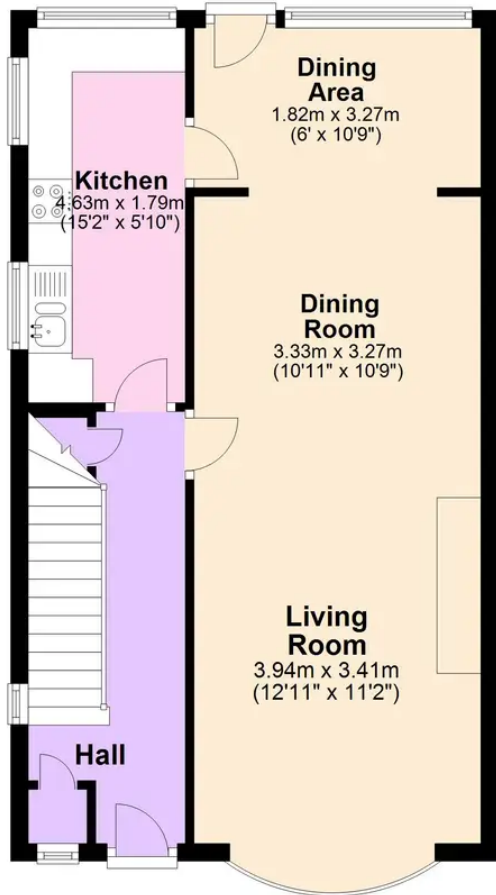

First Floor

Approx. 39.5 sq. metres (425.3 sq. feet)

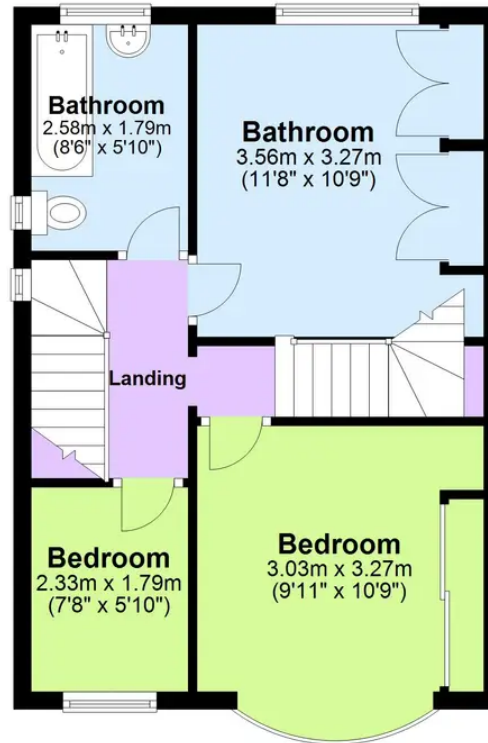

Second Floor

Approx. 20.2 sq. metres (217.3 sq. feet)



Total area: approx. 109.3 sq. metres (1176.3 sq. feet)

This floor plan is for illustrative purposes only and should be used as such by any prospective purchaser. Whilst every attempt has been made to ensure the accuracy of this plan, measurements of doors, windows, rooms and other items are approximate and no responsibility is taken for any error, omission or mis-statement.
Plan produced using PlanUp.

Coopers Estate Agents

Coopers, 22 New Union Street - CV1 2HN

024 7655 2841 • sales@coopersestateagents.com • www.coopersestateagents.com/

Coopers Chartered Surveyors Ltd, 22 New Union Street, Coventry, West Midlands

CV1 2HN, 024 7655 2841, sales@coopers-cov.com. Company Registration

Number: 6725089 / VAT number: 940 3555 34