

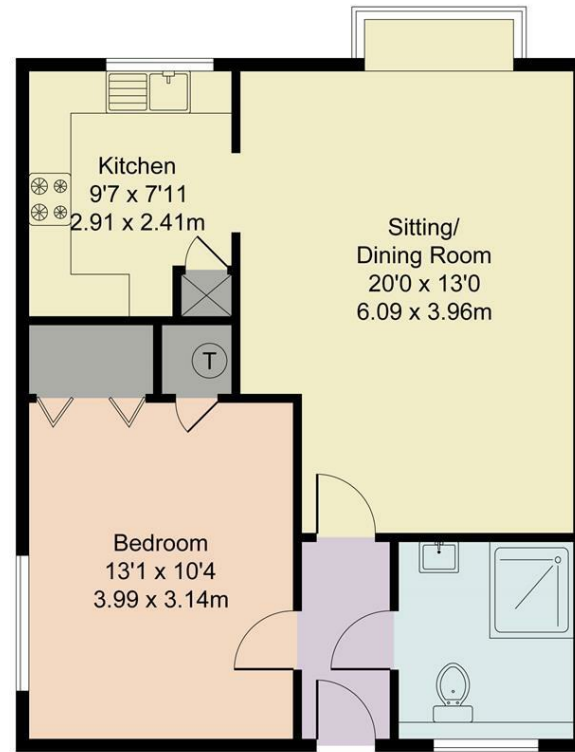

**War Memorial Place**  
Approximate Gross Internal Area 52.32 sq m / 563.16 sq ft



Ground Floor

Illustration for identification purposes only, measurements are approximate, not to scale.

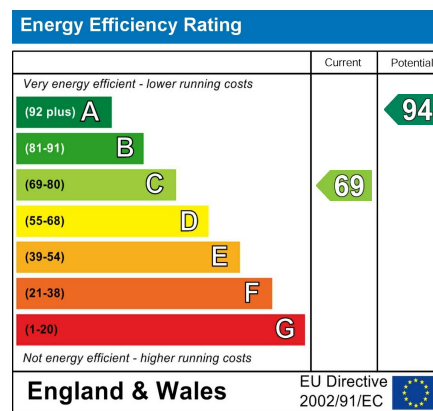

**Guide Price**  
**£269,000**

**War Memorial Place**

A spacious and well-appointed one-bedroom retirement bungalow nestled within a peaceful, purpose-built development.

- One bedroom retirement property
- Purpose built development
- On-site Manager
- Communal residents area
- Double bedroom with fitted wardrobe
- 20' reception room
- Communal gardens
- Parking

A one bedroom bungalow, situated with a purpose built development

- 📍 Henley Town Centre 1 mile
- 📍 Marlow 7 miles
- 📍 Reading 8 miles
- 📍 London 36 miles
- 📍 M4(J8/9) 11 miles
- ✈ Heathrow 24 miles





## Description

20 War Memorial Place is a spacious and well-appointed one-bedroom retirement bungalow nestled within a peaceful, purpose-built development in Henley-on-Thames. The property offers a comfortable and secure environment, designed for independent living with the convenience of a supportive community.

The entrance hallway provides access to all key areas of the home including the generously sized bedroom and the shower room. To the rear of the property is the living room, which features a large bay window offering beautiful views over the well-maintained communal gardens. Adjacent to the living room is a fully fitted kitchen, complete with a mix of integrated and freestanding appliances.



## The Development

War Memorial Place is a tranquil cul-de-sac development, thoughtfully designed and featuring a mix of bungalows and apartments. The development is set within beautifully landscaped communal gardens, providing a peaceful environment for residents. Additionally, the main building offers a comfortable sitting room, where residents can socialize and take part in a variety of organized activities.

Minimum age for couple or single person: 60 years.  
 Pets are permitted with permission  
 Service Charge (including Ground Rent) £240.00 pcm  
 Lease 99 years from 1989

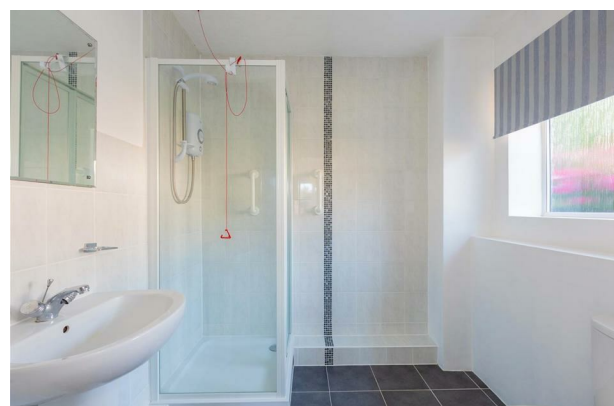

## Directions

Postcode - RG9 1EP

What3Words:///domestic.keyboards.masters



## Viewings

Viewing by prior appointment with Robinson Sherston Henley office.



Tel: 01491 411911  
 Email: [henley@robinsonsherston.co.uk](mailto:henley@robinsonsherston.co.uk)

## Sales Disclaimer

*IMPORTANT NOTICE: Nothing in these particulars shall be deemed to be a statement that the property is in good structural condition or that any services, appliances, equipment, or facilities are in good working order. Measurements and distances referred to are given as a guide only whilst descriptions of the property are subjective and are used in good faith as an opinion and not as a statement of fact. Purchasers must satisfy themselves by inspection or otherwise on such matters prior to purchase.*