



• mcgowan homes •

35 Heywood Court, Middleton



- Well Presented Two Bed First Floor Apartment
 - Double Glazed Windows
- Spacious Bay Lounge / Kitchen And Bathroom
 - Communal Lawned Gardens
 - Open Field Views

£109,995

Well presented two bed first floor apartment with open field views to the rear. Briefly comprising of double glazed windows, spacious bay lounge, kitchen, two bedrooms and a three-piece bathroom. Externally to the front are communal lawned gardens and steps to the entrance. At the rear are very pleasant open field views. Conveniently situated for access to Middleton town centre, transport links and the M60 motorway network.

ENTRANCE

Secure communal entrance with stairs to the first floor

HALL

Hall with sliding doors to storage. Access to living accommodation.

LOUNGE

5.99m x 4.31m (19'7" x 14'1")

Rear aspect with large bay window and laminated wooden flooring.



KITCHEN

2.65m x 2.08m (8'8" x 6'9")

Rear aspect with a range of wall and base units incorporating stainless steel sink, electric hob, electric oven, part tiled walls and tiled flooring.



BEDROOM 1

3.78m x 2.93 (12'4" x 9'7")

Rear aspect with carpet flooring.



BEDROOM 2

3.79m x 2.12m (12'5" x 6'11")

Rear aspect with carpet flooring.



BATHROOM

Three-piece bathroom comprising of bath with shower over, vanity wash-basin, low-level W.C, fully tiled walls, tiled flooring and heated towel rail.



OUTSIDE

Externally to the front are communal lawned gardens and steps to the entrance. At the rear are very pleasant open field views.

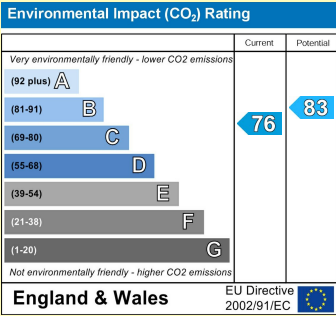
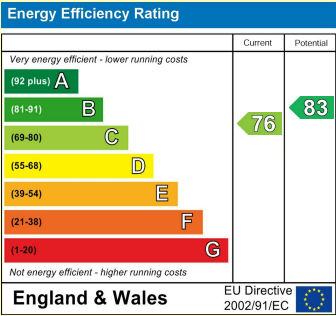

PLEASE NOTE: We have not checked the efficiency or operation of any services (Gas, Water, Electricity or Drainage) or any electrical, mechanical or heating appliances. All measurements taken via a sonic measure. Measurements should only be used as a guide and not for ordering any floor coverings or carpets. **Viewing Strictly By Appointment Only**

GROUND FLOOR
642 sq.ft. (59.6 sq.m.) approx.

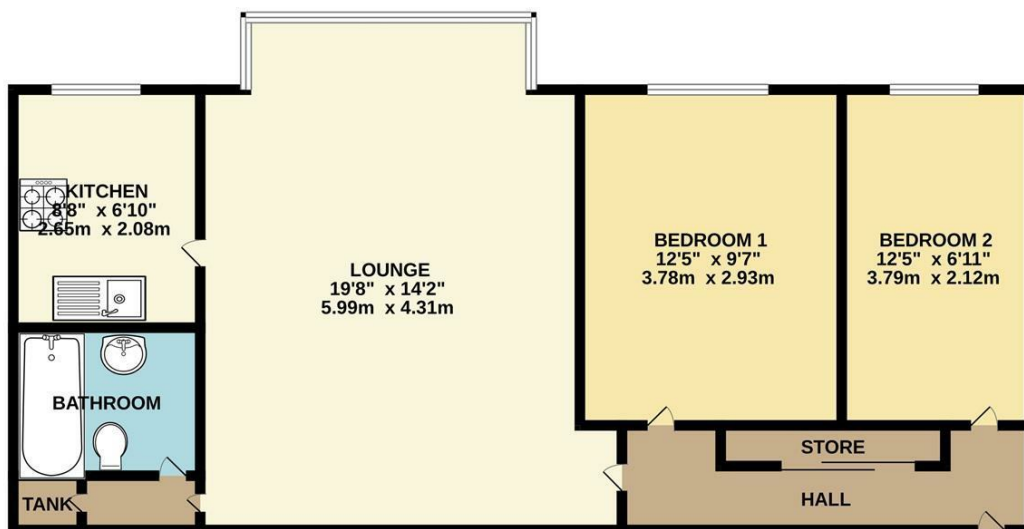

TWO BED FIRST FLOOR FLAT

TOTAL FLOOR AREA : 642 sq.ft. (59.6 sq.m.) approx.

Whilst every attempt has been made to ensure the accuracy of the floorplan contained here, measurements of doors, windows, rooms and any other items are approximate and no responsibility is taken for any error, omission or mis-statement. This plan is for illustrative purposes only and should be used as such by any prospective purchaser. The services, systems and appliances shown have not been tested and no guarantee as to their operability or efficiency can be given.
Made with Metropix ©2025

THINKING OF SELLING?

To find out why more homeowners are moving with McGowan Homes & Property Services, contact us for a free market appraisal of your home. We pride ourselves on a professional, efficient and friendly service. Let US take the worry out of your move.

TELEPHONE
0161 655 4113

YOUR HOME IS AT RISK IF YOU DO NOT KEEP UP REPAYMENTS ON A MORTGAGE OR OTHER LOANS SECURED ON IT.

43 Middleton Gardens, Middleton, Manchester M24 1AB

Telephone: 0161 655 4113

www.mcgowanhomes.co.uk

The above particulars are believed to be correct, but are not guaranteed, and form no part of any contract. No responsibility in respect of these particulars, which are supplied for guidance only and without liability, can be accepted by McGowan Home & Property Services, not by their clients, and any intending purchaser or lessee must satisfy himself by inspection or otherwise to the accuracy of all details contained therein. All property offered subject to availability. The Supply of Goods and Services Act 1982, does not apply to this brochure.