

# Leary Crescent |

Price £1,250 pcm



**Discover your new home with this delightful two-bedroom house. A good-sized hallway leads you to a modern kitchen. The inviting living area welcomes you with natural light, creating a warm and comfortable atmosphere.**

**The two double bedrooms upstairs offer great space for a couple or small family.**

**Outside, the enclosed garden is a great space, complete with shed to store your tools and garden equipment. The property also features off-street parking, ensuring your vehicle easily accessible.**

**Located in a sought-after area, this home is close to local amenities and transportation links.**

**Early viewing recommended.**

- Nil Deposit Option available
- 2 Double Bedrooms
- Good decorative order
- Gas Central Heating
- Double Glazing
- Council Tax Band B £1836.02
- EPC rating C
- Tenancy Deposit £1442
- Holding Deposit £288

Approx Gross Internal Area  
54 sq m / 577 sq ft

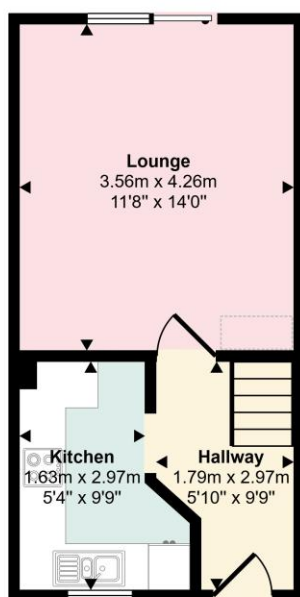

Ground Floor  
Approx 26 sq m / 284 sq ft

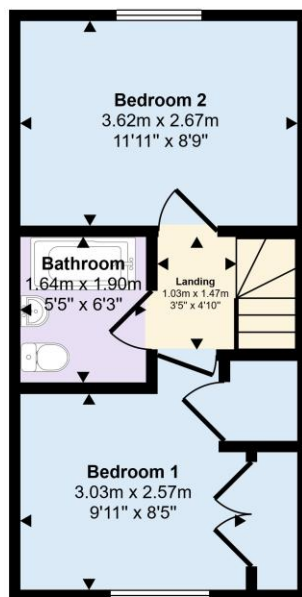

First Floor  
Approx 27 sq m / 293 sq ft

Denotes head height below 1.5m

This floorplan is only for illustrative purposes and is not to scale. Measurements of rooms, doors, windows, and any items are approximate and no responsibility is taken for any error, omission or mis-statement. Icons of items such as bathroom suites are representations only and may not look like the real items. Made with Made Snappy 360.