

Silbury Boulevard |  
Price £1,495 pcm

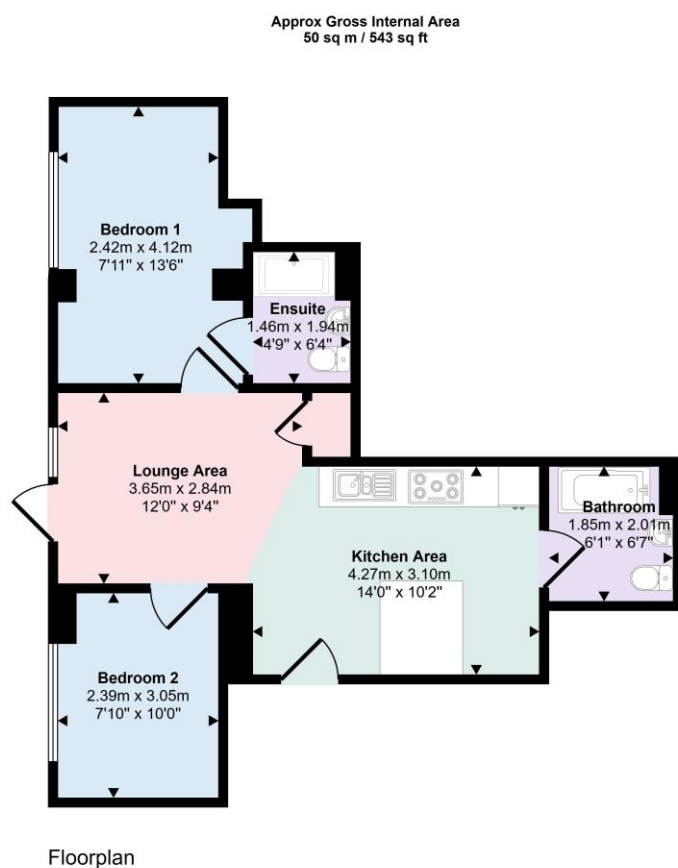

Prestigious location for this stunning 2 bed apartment offering modern open plan living within walking distance of the city centre and mainline rail station. Finished to a high specification with quality flooring and fitted kitchen with fully integrated Smeg appliances. Property is offered furnished

- Available for Immediate Let
- Prestigious City Centre Location
- Modern Open Plan Living
- 2 Double Bedrooms - Ensuite to Master.
- Finished to High Specification
- Security Buzzer Door Entry
- Lift and Stair access to all floors
- Allocated Parking Space with secure gated parking area
- Walking distance to City Centre
- Council Tax Band B



This floorplan is only for illustrative purposes and is not to scale. Measurements of rooms, doors, windows, and any items are approximate and no responsibility is taken for any error, omission or mis-statement. Icons of items such as bathroom suites are representations only and may not look like the real items. Made with Made Snappy 360.