



5 Morris Mews, Rugby Rise, Loudwater

£260,000



Robertsons

5 Morris Mews Rugby Rise

Loudwater, Buckinghamshire

A well presented second floor apartment in this popular development opposite Kingsmead playing fields, built by Banner Homes in 2004. Entrance hall, Kitchen, Sitting/Dining room with balcony, Two bedrooms, Bathroom, Electric central heating, Double glazing, Communal gardens, Allocated parking. NO CHAIN.

Council Tax band: C

Tenure: Leasehold

Entrance hall

Security entry phone, wall light point, built in storage cupboard, airing cupboard housing hot water cylinder and shelved storage

Sitting room

With doors to BALCONY, two radiators, two wall light points, wall thermostat, archway to kitchen, window to front

Kitchen

Fitted with a range of eye and base level units incorporating stainless steel sink unit with mixer tap and drainer, fridge/freezer and washing machine, fitted four ring Hotpoint hob with extractor over, part tiled walls, tiled flooring





Bedroom 1

With built in double wardrobe, radiator, door to Bathroom, windows to rear and side

Bedroom 2

Built in wardrobe, radiator, window to rear

Bathroom

White suite comprising panelled bath with mixer tap and Aqualisa shower over, low level W.C., wash hand basin with mixer tap, shaver point, fitted mirrored cupboard, part tiled walls, tiled flooring, window to side

Communal gardens

Principally laid to lawn

Parking

There is one allocated parking space close to the flat and further visitors parking



Approximate Gross Internal Area
Ground Floor = 59.4 sq m / 639 sq ft

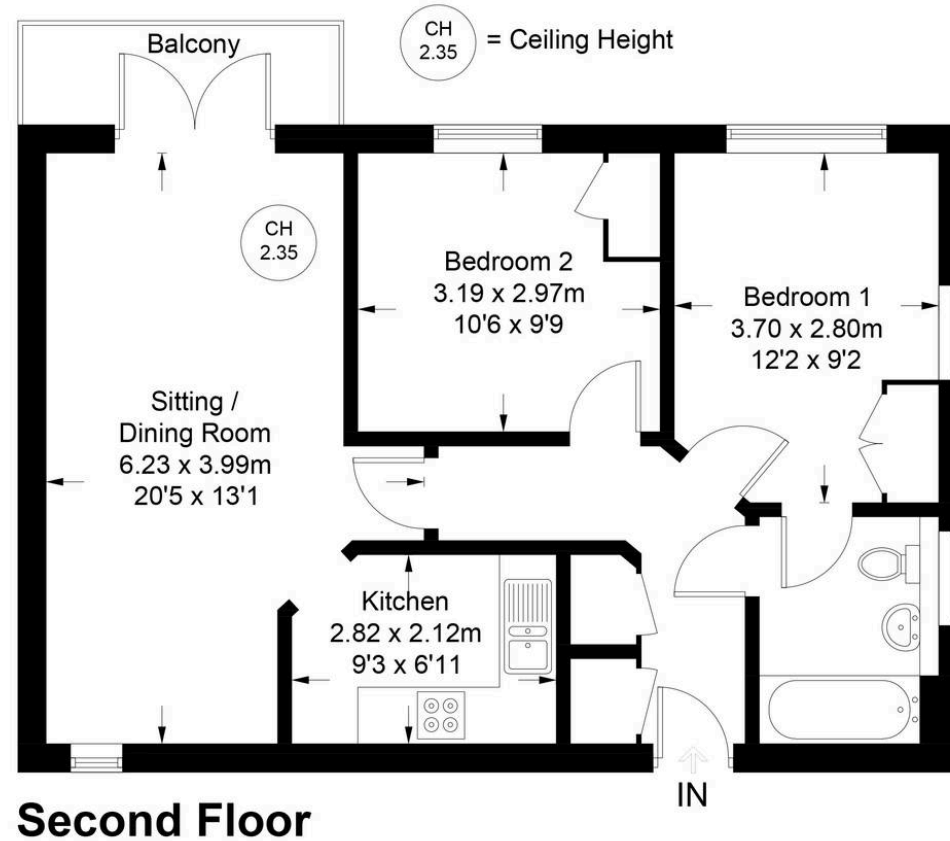

Floor Plan produced for Robertsons by Media Arcade ©.
Illustration for identification purposes only. Window and door openings are approximate. Whilst every attempt is made to assure accuracy in the preparation of this plan, please check all dimensions, shapes and compass bearings before making any decisions reliant upon them.