



6 Frank Lunnon Close, Bourne End

£380,000



## 6 Frank Lunnon Close

Bourne End, Bourne End

A well presented two bedroom freehold terraced home set in a quiet cul de sac within walking distance of Bourne End village centre. Bourne End is a thriving Thameside village with an excellent array of shops, pubs and restaurants. Entrance hall, Sitting room, Refitted kitchen/Breakfast room, Conservatory, Two bedrooms, Refitted Bathroom, Electric heating, Double glazing, Gardens, Allocated parking.

Council Tax band: TBD

Tenure: Freehold





### **Entrance hall**

Storage heater, stairs to first floor

### **Sitting room**

Storage heater, down lighters, under stairs storage cupboard, window to front, opening to Kitchen/Breakfast room

### **Kitchen/Breakfast room**

Refitted with a range of eye and base level units incorporating sink unit with mixer tap and drainer, built in Bosch oven, fitted four ring Bosch hob with Bosch extractor over, built in fridge/freezer, built in Zanussi slim line dishwasher, built in Zanussi washing machine, electric heater, wooden flooring, down lighters, window to rear, door to conservatory

### **Conservatory**

With doors to garden, electric heater, down lighters, dimmer switch

### **First floor**

### **Landing**

Access to loft space

### **Bedroom 1**

Built in wardrobe, airing cupboard housing hot water cylinder and shelved storage, electric heater, down lighters, dimmer switch, window to front

### **Bedroom 2**

Electric heater, down lighters, dimmer switch, window to rear

### **Bathroom**

Refitted white suite comprising panelled bath with mixer tap and Aqualisa shower over, low level W.C., wash hand basin with mixer tap and storage under, tiled walls, shaver point, heated towel rail, down lighters, window to rear

### **Front garden**

Laid to lawn with a pathway to the front door



## 6, Frank Lunnon Close

Approximate Gross Internal Area  
Ground Floor = 35.6 sq m / 383 sq ft  
First Floor = 25.3 sq m / 272 sq ft  
Total = 60.9 sq m / 655 sq ft

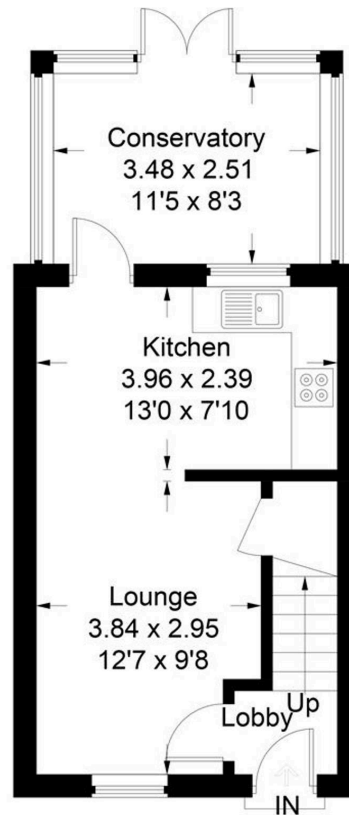

**Ground Floor**

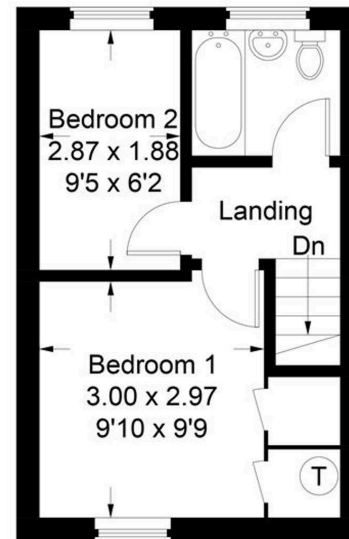

**First Floor**

This plan is for layout guidance only. Not drawn to scale unless stated. Windows and door openings are approximate. Whilst every care is taken in the preparation of this plan, please check all dimensions, shapes and compass bearings before making any decisions reliant upon them.  
© CJ Property Marketing Ltd Produced for Robertsons

## Robertsons Estate Agents

Swains House, Swains Lane, Flackwell Heath – HP10 9BN

01628 533373

[flackwellheath@robertsonsestateagents.co.uk](mailto:flackwellheath@robertsonsestateagents.co.uk)

[www.robertsonsestateagents.co.uk](http://www.robertsonsestateagents.co.uk)



**Robertsons**